



**MAHARASHTRA GRAMIN BANK**

(A Scheduled Bank established by Govt. of India.)  
Sponsor Bank : Bank of Maharashtra



**MAHARASHTRA GRAMIN BANK  
HEAD OFFICE: WALUJ MAHANAGAR,  
AURANGABAD (M.S.)**

**TENDER FORM  
INTERIOR FURNISHING WORK  
FOR NEW PREMISES, REGIONAL OFFICE, PUNE  
DISTT. PUNE. (M.S.)**

**LAST DATE FOR SUBMISSION OF TENDERS: 12.07.2022 (3.00 p.m.)**

**AT**

**HEAD OFFICE: PLOT NO 42, GROWTH CENTER, NAGAR- IV, CIDCO WALUJ  
MAHANAGAR, GOLWADI, AURANGABAD - 431010**

**TOTAL NO. OF PAGES = 44 NOS.**

**Including 02 No. of Drawings**



**MAHARASHTRA GRAMIN BANK**

(A Scheduled Bank established by Govt. of India.)  
Sponsor Bank : Bank of Maharashtra

## **MAHARASHTRA GRAMIN BANK**

Head Office: plot No 42, Growth Center, Nagar- IV, CIDCO Waluj Mahanagar,  
Golwadi, Aurangabad - 431010

### **TENDER NOTICE**

Sealed item rate tenders are invited from **empanelled contractors of Nationalised Banks/ Scheduled Banks only** for Interior furnishing works to be executed for **Maharashtra Gramin Bank, Regional Office Pune at first Floor, Distt. Pune. (M.S.)** The total work is to be completed within **45 days** time.

The blank tender document shall be available at the office of Maharashtra Gramin Bank, Head Office, plot No 42, Growth Center, Nagar- IV, CIDCO Waluj Mahanagar, Golwadi, Aurangabad - 431010, on payment of **Rs. 3000/- (Rupees Three Thousand only)** by D.D./ pay order as cost of tender form in the name of "Maharashtra Gramin Bank" payable at Aurangabad which is non-refundable. **Alternatively**, if the tender document is downloaded, the aforesaid cost of tender form shall be enclosed in the form of Demand Draft / Pay Order in name of "Maharashtra Gramin Bank" for the cost of tender form. **No cheques shall be accepted.**

The blank tender form shall be available from dated **18-06-2022 to 08-07-2022 during office hours upto 17.00 Hrs on 08-07-2022** and they are to be submitted at the above address on or before **12-07-2022 up to 15.00 Hrs.** duly filled in along with a Demand Draft/Pay order drawn for **Rs. 40,000/- (Rupees Forty Thousand Only)** from any **Nationalised Bank/ Scheduled Bank** in the name of "Maharashtra Gramin Bank", towards Earnest money deposit. **No cheques shall be accepted.**

The tender will be opened on **12-07-2022 at 15.30 Hrs.** in the presence of the contractors present at that time. **Tenders without Earnest money deposit will not be considered and shall be outrightly rejected.** Tender cost/EMD exemption will be as per government rules applicable to **MSME**. Please submit relevant registration certificates in respective category & heads. If the registration is not found in suitable category, the tender shall be summarily rejected.

Tenders received **Late after** the date and time of Submission either personally or by post or postal delay will not be considered and summarily will be treated as rejected.

**Maharashtra Gramin Bank** reserves the right to accept or reject any or all tenders either in whole or in part, without assigning any reasons.

A set of layout plans, drawings and preliminary details will be issued as part of Tender documents, which are to be returned duly signed with seal along with the tender submission.

Time of Completion 45 Days

Liquidated damages for delay @1% of the tendered amount shown in the tender per week will be levied till the completion of the work ( subject to 10 % of the accepted contract sum).

**The bank will not be bound to accept the lowest tender and reserves the right to accept or reject any or all the tenders without assigning any reasons whatsoever.**

**Signature of Contractor /  
Tenderer with seal**

**Chairman**  
Maharashtra Gramin Bank  
Head office, Aurangabad (M.S.)

## NOTICE TO TENDERERS:

1. Sealed item rates tenders shall be addressed to the **Chairman, Maharashtra Gramin Bank, Head Office, plot No 42, Growth Center, Nagar- IV, CIDCO Waluj Mahanagar, Golwadi, Aurangabad - 431010** and super scribed as “Tender for Proposed Interior furnishing works to be executed for Maharashtra Gramin Bank, Regional Office Pune at first Floor, Distt. Pune. (M.S.) for **Maharashtra Gramin Bank HO Aurangabad** (Maharashtra) and sent so as to reach this office **not later than 15.00 hours on the 12th** day of July 2022. Tender should be accompanied with **Earnest Money Deposit (EMD) of Rs. 40,000/- (Rupees Forty Thousand Only) in the form of Demand Draft in favour of Maharashtra Gramin Bank payable at Aurangabad.** Tenders **not** accompanied with EMD shall be rejected and considered invalid. The earnest money shall be returned to the tenderer if the tender is not accepted but without any interest. EMD amount deposited by the tenderer, whose tender is accepted, shall be adjusted towards security deposit to be **retained by the Bank for one year.**
2. **Tender cost/EMD exemption will be as per government rules applicable to MSME. Please submit relevant registration certificates in respective category & heads. If the registration is not found in suitable category, the tender shall be summarily rejected.**
3. No tender shall be accepted after **15.00 hours** on the **12th day of July 2022** Tenders received **Late after** the date and time of Submission either personally or by post or postal delay will not be considered and summarily will be treated as rejected
4. Tenders will be opened in the office of **Chairman, Maharashtra Gramin Bank, Head Office, plot No 42, Growth Center, Nagar- IV, CIDCO Waluj Mahanagar, Golwadi, Aurangabad - 431010** **on 12th** day of **July 2022 at 15.30 hours** by the The Chairman or his nominee / Authorised representative. The rates tendered by the contractors shall be valid for acceptance for minimum **120 days** from the date of opening.
5. **The Chairman, Maharashtra Gramin Bank, Head Office, plot No 42, Growth Center, Nagar- IV, CIDCO Waluj Mahanagar, Golwadi, Aurangabad - 431010** does not bind himself to accept the lowest or any tender and reserves the right to accept or reject any or all the tenders whether in whole or in part without assigning any reason for doing so. The owner reserves his rights to negotiate with the lowest or any other tender/s.
6. Each of the tender documents is required to be signed by the person or persons submitting the tender in token of his/ their having acquired himself/ themselves with the general conditions, articles of agreement, mode of measurements, schedule of probable quantities, site conditions and the time schedule etc. as laid down. Any tender with any of the documents not signed will be liable to be rejected.
7. Tenderer shall fill in rates for all items of work described in the Annexure. All entries must be made by hand and in ink. **The rates quoted for the items shall compulsorily be in “Figure” & “Words” in English.** (For example- Rate in figures written is **Rs. 2150/-** , in words it shall be written **Rs. Two Thousand, One Hundred & Fifty only**). In the event of discrepancy between the rates quoted in figures & words, the rates quoted in words, shall be binding. **Tender not quoted in above said manner will be rejected & will not be considered.** Items against which no rate is entered by the tenderer will not be paid for by the Employer/ Bank when executed and shall be deemed covered by the other rates in the Annexure. If any of the documents is missing or unsigned the tender shall be considered invalid.

8. All erasures and alterations made while filling the tender must be attested with initials of the tenderer. Overwriting of figures is not permitted. Failure to comply with either of these conditions will render the tender invalid.

9. All the pages of the tender documents should be signed by the tenderer.

**10. The security deposit shall be kept with the Bank for a period of 12 months after the Architect issues the completion certificate which amount is not to bear interest.**

. The rates quoted by the contractor should include all charges for scaffolding materials labour, hire for any tools, marking out and clearing of the site as mentioned in the specifications. The rate quoted by the tenderer in the Annexure of probable quantities will be deemed to be for the finished work to be measured at site. The rates shall be inclusive of all sales tax, GST , works contract tax, Provident Fund, Insurance etc. levied by any Government or any public body. The contractor shall abide by the rules of Minimum Wage Act and Child Labour Act and keep the owner indemnified regarding the same. The contractor should take necessary insurance for the work as required under the workman compensation act, labour laws etc. as prevailing.

12. The rate shall be binding to the Contractor, for all the tender items till the completion of the work respective of variation in market rates of material and labour.

13. The calculations made by the tenderer should be based upon probable quantities of the several items of work, which are furnished for the tenderers convenience in the Annexure. It must be clearly understood that the contract is not a lump-sum contract that neither the probable quantities nor value of the individual and the aggregate value of the entire tender will form a part of the contract and that Architect doesn't in any way assure the tenderer or guarantee that the said probable quantities are correct or that the work would correspond thereto.

14. The items against which no quantity is shown in Annexure for which tenderer is to quote his rates and the Employer/ Bank at his description shall ask the contractor to execute those items if required and which shall be binding on the part of the contractor to execute those items at the rates quoted therein in the tender.

15. The successful tenderer should make their own arrangements to obtain all materials required for the work.

16. The various materials stored on site shall be protected from the fire, floods or rains etc. and the contractor shall be responsible for any damage caused to the owner for the same.

17. The contractor shall allow enough facilities to the sub-contractors employed by the owner and should co-operate with them and that small holes etc. made by these sub-contractors to the structure shall be properly corrected by the general contractor without any prejudice and extra cost whatsoever.

18. The bills shall be prepared by the contractor in the manner required by the Architect and should be submitted to him. All payments by the Employer/ Bank under this contract shall be made at Aurangabad (M.S).

19. The specifications that are not mentioned or listed in the tender shall **conform to I.S.I. Specifications** while having prior written consent of the Architect.

20. In case of dispute regarding quality of material, workmanship etc. Shall be accepted as final decision **given by the competent Authority of the Bank.**

21. The contract shall be subject to Aurangabad jurisdiction only.

22. The Architect reserves the right to deduct such amounts as he may feel proper on account of bad workmanship as penalty and that his decision in such matters shall be binding to both the parties and shall not be subject to arbitration. In case the contractor's progress of work is not satisfactory or his workmanship is not to the standard quality, the architect and/or owner / Bank reserve the right to issue necessary notice to the contractor, for carrying out timely progress. If however the contractor has not improved the progress, the architect and/ or owner / Bank can release the contractor from his work and terminate the contract after issuing seven days notice.

23. The Bank reserves the right to omit any item or items or part thereof for which contractor shall not claim any compensation whatsoever.

**24. Contractor must inform in writing to the Architect before executing any work that is not covered in Tender or any quantities of the tendered item that are increasing while executing the work. Prior permission from the Employer/ Bank shall be obtained before executing any such item.**

25. The Architect for this work is **Ashish Shyamkishor Nashine, 49, Central Bazar Road, Bajaj Nagar, Nagpur-440010** and the architect reserves the right to deduct such amounts as he may feel proper on account of bad workmanship as penalty with the consent of Bank/ Employer and that his decision in such matters shall be binding to both the parties and shall not be subject to arbitration.

I/ We hereby declare that I/We have read and understood the above instructions for the guidance of the Tenderer.

Date:

Seal

**Signature of the Contractor/**

**Tenderer with Seal**

**SPECIAL CONDITIONS OF THE CONTRACT:-**

1. The tender is to be properly filled and endorsed and to be quoted in full.
2. The contractor should quote in figures as well as in words the rate and amount tendered by them. The amount for each item should be worked out and the requisite totals given.
3. THE CONTRACTORS SHALL QUOTE THE EXACT WORKING RATES OF ITEMS & **NO REBATE / DISCOUNT IN PERCENTAGES** SHALL BE CONSIDERED AS IT IS AN ITEM RATE TENDER WITH THE PRICE BID, THE RATES QUOTED WILL ONLY BE TAKEN INTO ACCOUNT. HOWEVER DURING THE PERIOD OF NEGOTIATION IF ANY AS THE AUTHORITIES MAY DEEM FIT TO SHALL BE CONSIDERED DURING THE PROCESS OF NEGOTIATIONS WHILE ACCEPTANCE OF THE TENDER.
4. The rates to be quoted are on item rate basis and are to be inclusive of everything including all the taxes involved viz sales tax, GST on raw material, works contract tax, excise duty, material cost, labour, transportation etc. complete.
5. HOWEVER, RATES QUOTED FOR COMPLETED FINISHED ITEMS SHALL BE EXCLUSIVE OF GST (GOOD & SERVICE TAX) WHICH SHALL BE PAID SEPARATELY ON THE ACTUAL BILL AMOUNT BY BANK.
6. **Earnest Money and Initial Security Deposit** An amount of **Rs. 40,000/- (Rupees Forty Thousand Only.)** shall be paid by Demand draft/Pay order as Earnest Money Deposit at the time of tendering in the name of the bank. On acceptance of Tender and offer letter of work, the successful tenderer shall deposit a further amount to make it 2% of approved Tendered amount with the bank as initial security deposit
7. Tender cost/EMD exemption will be as per government rules applicable to MSME. Please submit relevant registration certificates in respective category & heads. If the registration is not found in suitable category, the tender shall be summarily rejected.
8. **VALUE OF INTERIM PAYMENT**

**The minimum value of work done entitling the contractor to receive an interim payment shall be Rs.20,00,000/- ( Twenty Lakhs only) for the work done & completed works.** However, the competent authority can at his discretion certify for interim payment for a lesser value also. The period of honouring interim certificate shall be 15 days from the dates of receipt of the certificate from the architect.

9. **Interim payment shall be paid to the contractor** till the completion of contract. The minimum amount of the each interim bill shall be **Rs.20,00,000/- ( Twenty Lakhs only)** From the interim bill an amount of 10% of tendered amount will be deducted towards retention amount inclusive of initial Security deposit & Earnest money deposit. ie The retention percentage (ie deduction from interim bill) shall be 8% of gross value of each interim bill. The final bills shall be scrutinized within 15 days from the Date of completion, and the period of honoring the same shall be One month. Half of the retention amount i.e. 5% of the work shall be paid with the final Bill. The final 5% retention amount of the work will be kept as Security deposit and will be released only after **12 months** from the date of virtual completion of work as certified by the Bank's Architect. The retention amount shall carry no interest whatsoever.
10. Total Security deposit shall comprise of
  - a) Earnest Money Deposit,
  - b) Initial Security Deposit
  - c) Retention Money
11. **Tender's acceptance:** The Bank reserves the right to accept / reject any or all tenders without assigning any reasons for rejection/acceptance whatsoever. The tenderer whose tender is accepted will have to enter in to an agreement immediately on being informed to do so. In case of failure on the part of tenderer to sign the agreement within the stipulated time, the earnest money paid by him shall stand forfeited to bank and the offer of the tenderer shall be considered as withdrawn by him.
  12. The work is to be carried out in New premises of Bank & the time period provided for completion of work is inclusive of load shedding hours. The contractor should make his own alternative arrangements at his own cost to compensate with load shedding hours & no additional remuneration shall be paid for such arrangements nor any additional time will be granted on this accounts.
  13. The tenderer shall be presumed to have carefully examined the Site, Site Conditions and specifications of the work and have fully acquainted themselves with all details of the site and with all the necessary information and data pertaining to the work prior to tendering for the work.

14. The tenderer may in the forwarding letter mention any points he may wish to make clear but right is reserved to reject the same or the whole of the tenders if the same becomes conditional tender thereby.

15. All pages of document, conditions, specifications, drawings and plans etc. shall be initialed by the tenderer. The tender should bear full signature of the tenderer.

16. The Chairman or his duly authorized Officer shall open the tenders in the presence of intending contractors who may be present at the time of opening and will enter the amount of tenders in a comparative statement in a suitable form. In the event of a tender being accepted, the contractor shall thereupon, for the purpose of identification sign copies of specifications and other documents. In the event of a tender being rejected the Bank shall refund the amount of earnest money deposited to the tenderer, on his giving a receipt for the return of money.

**17. The drawings, details and the Specifications are only indicative and the schedule of quantities are only tentative. Any changes/additions/deletions/alterations in them shall be accommodated while executing the work without any prejudice. Any extra items or variations upon the schedule items shall be scrutinized by the Architect of the Bank and his decision shall be final and binding in all respects.**

18. Specifications of various materials and quality of work shall be the essence of the contract along with the time period and these shall be strictly adhered to

19. LIQUIDATED DAMAGES @ 1% OF THE TENDERED AMOUNT SHOWN IN THE TENDER PER WEEK TO A MAXIMUM LIMIT OF 10% OF THE CONTRACT SUM / ACCEPTED TENDERED AMOUNT, WHICH SHALL BE CHARGED FOR ANY DELAY IN THE COMPLETION OF THE WORK BEYOND THE STIPULATED TIME AND THIS CLAUSE SHALL BE STRICTLY FOLLOWED.

20. The contractor shall produce **the labour insurance policy**, the same will be reimbursed to the contractor. If contractor fails to produce the labour insurance policy, the competent authority / Bank shall **draw the policy**, the amount **Two Times** amount of expenditure incurred for drawing the policy shall be recovered as penalty from the 1st R.A bill of the contractor as penalty to the contractor.

21. Extra items, if any shall be paid on the basis of cost of materials (inclusive of all the Taxes as already mentioned) and labour plus 15% towards overheads and profits and items rates already accepted shall form the basis of this Contract.

**22. The Bank Authorities at their discretion may delete any part of item or item in full as they may feel necessary during the course of execution and no compensation will be paid /claimed in this regard. The contractor shall not claim any compensation towards such items.**

**23. The work shall be executed by the Contractor at his own risk and responsibility and the Bank shall not be held liable for any accidents/unforeseen events directly/indirectly and the Contractor understands clearly that no claim for any accidents or loss of life whatsoever shall be entertained by the Bank.**

24. Electric meter shall be arranged by Bank in its name but payment of electricity charges at site for execution of work shall be payable by Contractor, Alternatively the payments against the electric bills shall be deducted from the bills of contractor.

**Signature of Contractor/  
Tenderer with seal**

## **Manner of Submission of Tender:**

**The tenders to be submitted in two separate Sealed Envelopes as below:**

### **Envelope No.1 -Technical Bid**

The first envelope clearly marked, as 'Envelope No.1- Technical Bid' shall contain the following Documents.

- 1) Crossed Demand draft of any **Nationalized /Scheduled Bank** for the said amount as cost of Blank Tender form which is Non-refundable **No cheques shall be accepted.**
- 2) Crossed Demand draft of any **Nationalized /Scheduled Bank** for the said amount as **Earnest money deposit (EMD) No cheques shall be accepted.** Tender cost/EMD exemption will be as per government rules applicable to MSME. Please submit relevant registration certificates in respective category & heads. If the registration is not found in suitable category, the tender shall be summarily rejected.
- 3) **If the firm is a partnership firm**, attested copy of registered partnership deed registered with office of sub-registrar along with certificate of registration (**form 'H' under rule 17**) under partnership Act, 1932.
- 4) Attested copy of **Registered general power of Attorney** registered in the office of sub-registrar in case of partnership firm, who is authorized signatory on behalf of the partnership firm & its partners.
- 5) Attested copies of **Memorandum of Association** & Certified copy of Resolution in case of any Private Limited/Public Limited Companies.
- 6) Attested copy of Solvency Certificate for **Rupees Thirty Five Lakhs** from any **Nationalized/ scheduled Bank** of within a period of 12 months on the date of Receipt of this Application. Solvency certificate of other than **Nationalized/ Scheduled Bank shall not be considered.**
- 7) Copy of **Work Orders and performance certificate for completion of similar type of works/Empanelment letter of Banking organization for which work completion certificates** for Satisfactory completion of similar type of works as detailed below shall be enclosed.
- 8) **EPFO Registration is mandatory** and copy of registration Certificate should be **enclosed. The EPFO registration certificate should be of before date from the date of publication/floating/issue date of Tender. Without EPFO registration certificate the Tender is liable to be rejected**
- 9) Contractor shall enclose **work completion certificates** for satisfactory completion of similar type of works in last Five financial years of **Total value of Rs. 100 Lakhs: Total three works costing of value Rs. 100 Lakhs of which minimum one work costing 35 Lakhs / Two works of Total Rs. 50 Lakhs with one works costing minimum value of Rs.35 Lakhs amount or single work of minimum value Rs. 100 Lakhs amount for similar type of Interior Furnishing Works from Banking organization.**
- 10) **In addition to above Income Tax returns for last five years along with audited Balance sheets certified by CA shall be enclosed.**
- 11) **Copy of GOODS & SERVICE TAX CERTIFICATE (GST) shall be enclosed.**
- 12) **Copies of PAN card, Adhar card as Applicable shall be enclosed.**
- 13) Technically Qualified Engineer/ Supervisor should be available @ site who has understanding of the drawings and execution of works. His name along with his qualification and **consent letter** should be enclosed in envelope No. 1 who shall be available @ site during the progress of work.
- 14) An undertaking on Rs.100/- Stamp paper is to be enclosed stating that I/we/Firm has not been black-listed in any of the financial institutions/Banks & not found guilty of any misconduct.

**IMPORTANT NOTE: IF AT THE TIME OF VERIFICATION OF DOCUMENT IT IS FOUND THAT DOCUMENTS ENCLOSED ARE NOT IN ORDER, THE TENDER IS LIABLE TO BE REJECTED**

### **Envelope No.2 - Price Bid**

The second envelope clearly marked, as 'Envelope No.2- Price Bid' shall contain only the completed Tender document/ price bid along with the drawings and details issued with the blank tender forms duly signed by the Contractor should be enclosed.

**If the Bank is satisfied with papers enclosed in the first envelope then only the Envelope No. 2 shall be Opened.**

**Note:** - The Tenders are to be submitted in Two separate sealed envelopes as mentioned above, and the two separate sealed envelopes are to be **put in one common sealed cover**, the contractor shall mention over the common sealed cover that envelope no. 1 & envelope no.2 are inside the common sealed cover. While opening if it is found that the two separate sealed envelopes are not inside the common sealed cover the tender shall be outrightly rejected.

Signature of Contractor/  
Tenderer with seal

Chairman  
Maharashtra Gramin Bank  
Head office, Aurangabad (M.S.)



## **GENERAL CONDITIONS OF THE CONTRACT**

**The work consists of Interior furnishing works to be executed for Maharashtra Gramin Bank, Regional Office Pune at first Floor, Distt. Pune. (M.S.)**

### **1. INTERPRETATION**

In construing this conditions, the specification, the schedule of quantities, tender and Agreement, the following word shall have the meaning herein assigned to them except where the subject or context otherwise requires;

- i) Employer: The term Employer shall denote Chairman Maharashtra Grahmin Bank, Head Office, Aurangabad and any of its employee representative authorized on their behalf.
- ii) Architects / Consultants: The term architect shall mean Ashish Shyamkishor Nashine, 49, Central Bazar Road, Bajaj Nagar, Nagpur-440010 or in the event of his / their ceasing to be Architect for the purpose of this contract such other person/s as Employer shall nominate for the purpose. The Architect with the approval of Bank/Employer may engage a local Architect / Consulting Engineer for supervision and co-ordination of the work at the site. He will be considered a representative of the Architect
- iii) Contractor: The term contractor shall mean (Name and address of the contractor) and his / their heirs, legal representative, assign and successors.
- iv) Site : The site shall mean the site where the work are to be executed as shown in site plan including any building and erections thereon allotted by the Employer/Bank for the contractor use.
- v) Drawings: The work is to be carried out Strictly in accordance with the drawings, specification, the schedule of quantities and any further drawings which may be supplied or any other instruction, which may be given by the Employer during the execution of work.

All drawings relating to work given to contractor together with a copy of schedule of quantities are to be kept at site and the Employer /Architect shall be given access to such drawings or schedule of quantities whenever necessary.

In case any detailed drawing are necessary contractor shall prepare such detailed drawing and / or dimensional sketches therefore and have it confirmed by the Employer/ Architects as case may be prior to taking up such work.

The Contractor shall ask in writing for all clarification on matter occurring anywhere in drawings, specification and schedule of quantities or to additional instructions at least 7 days ahead from the time when it is required for implementation so that the employer may be able to given decision there on.

“The Works” shall mean the work or works to be executed or done under this contract.

“The schedule of quantities” shall mean the schedule of quantities as specified and forming part of Tender/ contract.

“Priced Schedule of Quantities” shall mean the schedule of quantities duly priced with the accepted quoted rates of the contractor.

## 2.SCOPE

Employer / B a n k / Architect may in their absolute right issue further drawings and/ or written instruction, detail, direction and explanations, which are, hereafter collectively referred to as “The Employer’s/ Architects Instruction” in regard to:

**a)The variation or modification of the design quality or quantity of works or the addition or omission or substitution of any work.**

b) Any discrepancy in the drawing or between the schedule of quantities and/ or drawing and / or specification.

c) The removal from the site of any defective material brought thereon by the contractor and the substitution of any material thereof.

d) The demolition removal and / or re-execution of any work executed by the contractor/s.

e )The dismissal from the work of any person employed there upon.

f)The opening up for the inspection of any work covered up.

g)The rectification and making good of any defect under clauses hereinafter mentioned and those arising during the maintenance period (retention period).

The Contractor shall forthwith comply with and duly execute any work comprised in such employer’s or Architect’s instruction’s, provided always that verbal instructions, direction and explanations given to contractor’s or his representative upon the work by employer or Architect shall, if involving a variation, be confirmed in writing to the contractors within seven days. No works for which rates are not specifically mentioned in the priced schedule of quantities shall be taken up without written permission of the Employer or Architect. Rates of items not mentioned in the priced schedule of the quantities shall be fixed by the Employer in consultation with the Architect as provided in Clause ” Variation”

## 3. TENDERER SHALL VISIT THE SITE

Intending tenderer shall visit the site and make himself thoroughly acquainted with the local site condition, nature and requirement of the works, facilities of transport condition, effective labour and material, access and storage for materials and removals of rubbish. The tenderer shall provide in their tender for cost of carriage, freight and other charges as also for special difficulties and including police restriction for transport etc. for proper execution of work as indicated in the drawings. The successful tenderer will not be entitled to any claim of compensation for difficulties faced or losses incurred on account of any site condition which existed before the commencement of work or which in the opinion of the employer or Architect might be deemed to have reasonably been inferred to be so existing before commencement of work.

## 4.TENDERS

The entire set of **Tender** paper along with preliminary set of drawings issued to tenderer downloaded from website should be submitted fully priced and also signed on every page. Initial / signature will indicate the acceptance of the tender by the tenderer.

The schedule of quantities shall be filled in as follows:

- i) The “Rate” column to be legibly filled in the ink in both English figures and English Words.
- ii) Amount column to be filled in for each item and the amount for each sub head as detailed in the “Schedule of Quantities”.
- iii) All corrections are to be initialled.
- iv) The “Rate Column” for the alternative item of which the quantities are not mentioned shall not be filled up.
- v) The “Amount Column” for alternative item of which the quantities are not mentioned shall not be filled up.

- vi) In case of any errors/ omission in the quoted rates, the rates given in the tender marked “Original” shall be taken as correct rates.

No modifications, writing or corrections can be made in the tender paper by the tenderer

The Employer reserve the right to reject the lowest or any tender and also to discharge any or all of the tenders for each section or to split up and distribute any item of work to any specialist firm or firms, without assigning any reason.

The tenderer shall note that the tender is strictly on the item rate basis and their attention is drawn to the fact that rates for each and every item should be correct, workable and self supporting. If called upon by the Employer/ Architect detailed analysis of any or all the rates shall be submitted. The Employer/ Architect shall not be bound to recognize the contractor analysis.

**The work will be paid for as “measured work” on the basis of actual work done and not as “lump sum” contract, unless otherwise specified.**

**The Mode Of Measurement / The Method Of Measurement shall be as per IS: 1200 based on the Specification and Trades**

All the item of work described in the schedule of quantities are to be deemed and paid as complete work in all respect and details including preparatory and finishing works involved, directly, related to and reasonably detectable from the drawing, specification and schedule of quantities and no further extra charges will be allowed in this connection. In the case of Lump-sum charges in the tender in respect of any items of work, the payment of such item of work will be made for the actual work done on the basis of lump-sum charges as will be assessed to be payable by the Employer/Architects.

**The Employer / Bank / Architect has power to add to, omit from any work as shown in drawing or described in specification or included in schedule of quantities and intimate the same in writing but no addition, omission or variation shall be made by the contractor without authorization from the Employer / Bank / Architect. No variation shall vitiate the contract.**

The tenderer shall note that his tender shall remain open for consideration for a period of **One Hundred and Twenty days ( 120 days)** from the date of opening of the tender.

## **5.AGREEMENT**

The successful contractor may be required to sign agreement as may be drawn up to suit local conditions and shall pay for all the stamps and legal expenses, incidental hereto.

## **6.PERMIT AND LICENSE**

The contractor shall arrange the Permit and License for release of materials that are under Government control. The Employer shall render necessary assistance, sign any form or application that may be necessary. The basic price of controlled material, if any, for the purpose of valuing the tender, is to be considered as stipulated below. This shall also be the basis of adjustment in setting the contractor’s bills.

The contractor shall at his own cost arrange for storage shed adequate for taking delivery and storing of the quantity of controlled material released by the authorities or supplied by the Employer. The costs of storing, transporting etc. of all materials including those under Govt. Control are to be included by the tenderer in his quote rates. No extra or separate rate will be claimed for this.

## **7.GOVERNMENT AND LOCAL RULES**

The contractor shall confirm to the provisions of all local bye-laws and Act relating to work and to the regulation, etc. of the Govt. and Local Authorities and of any company with whose system the structure is proposed to be connected. The contractor shall give all notices required by said Act, Rules, Regulation and Bye-laws etc. and pay all the fees payable to such authority/ authorities for the execution of work involved. The cost, if any, shall be deemed to have been included in his quoted rates, taking into account all liabilities for license, fees for footpath encroachment and restorations etc. and shall indemnify the Employer against such liabilities and shall defend all actions arising from such claims or liabilities.

## 8. TAXES AND DUTIES

The tenderer must include in their tender prices quoted for all duties royalties, ceases and sales tax GST or any other taxes or local charges if applicable.

No extra claim on this account will in any case be entertained.

## 9. QUANTITY OF WORK TO BE EXECUTED

**The quantities shown in the schedule of quantities are intended to cover the entire new structure indicated in the drawings but the Employer reserves the right to execute only a part or the whole or any excess there of without assigning any reason.**

## 10. OTHER PERSON ENGAGED BY THE EMPLOYER

The Employer reserve the right to execute any part of the work included in this contract by other Agency or persons and contractor shall allow all reasonable facilities and use of its scaffolding for the execution of such work. The main contractor shall extend all cooperation in this regard.

### . EARNEST MONEY AND SECURITY DEPOSIT

The Tenderer will have to deposit EMD for an amount of **Rs. 40,000/- (Rupees Forty Thousand Only.)** in the form of Bank Draft drawn in favour of **"MAHARASHTRA GRAMIN BANK"** payable at **Aurangabad** at the time of submission of tender as an earnest Money deposit. The Earnest Money deposit of the unsuccessful tenderer will be refunded without any interest soon after the issue of work order to the successful tenderer or after the expiry of the validity period of the tender.

Tender cost/EMD exemption will be as per government rules applicable to MSME. Please submit relevant registration certificates in respective category & heads. If the registration is not found in suitable category, the tender shall be summarily rejected.

The successful tenderer to whom the contract is awarded will have to deposit as initial security deposit a further sum to make up 2 % of the accepted tender including the Earnest Money deposit. The initial Security Deposit will have to be made on intimation from the date of acceptance of tender, failing which the employer at his discretion may revoke the letter of acceptance and forfeit the Earnest Money Deposit furnished along with the tender.

Apart from the Initial security Deposit made as above, retention money shall be deducted from progressive running bills @ 8% of the gross value of each interim bill until the total security Deposit, i.e., the initial Security Deposit plus the retention money equals total 10% of the final bill amount

### VALUE OF INTERIM PAYMENT

**The minimum value of work done entitling the contractor to receive an interim payment shall be Rs.20,00,000/- (Twenty Lakhs only) for the work done & completed works.** However, the competent authority can at his discretion certify for interim payment for a lesser value also the period of honouring interim certificate shall be 15 days from the dates of receipt of the certificate from the architect.

### Period of honouring final certificate

The period shall be 6 weeks from the date of receipt of the final certificate from the Architect.

the amount 50% of the retention amount is refunded to the contractor on

- i) Issue of virtual completion certificate by the Architect/ Premises Department.
- ii) contractors removal of his materials, equipment, labour force, temporary sheds/ stores etc. from the site. (excepting for a small presence required if any for the defect liability period and approved by the bank).

The remaining 50% of retention amount may be refunded to the contractor 14 (fourteen) days after the end of defects liability period provided he has satisfactorily carried out all the work and attended to all defects in accordance with the conditions of contract.

### **Defects Liability Period (DLP)**

The defect liability period (DLP) shall be 12 months. The DLP commences from the certified date of virtual completion issued jointly by the banks premises department and the Architects

### **12. CONTRACTOR TO PROVIDE EVERYTHING NECESSARY**

**The contractor shall provide everything necessary** for the proper execution of the work according to the intent and meaning of the drawings, schedule of quantities and specification taken together whether the same may or may not be particularly shown or described therein provided that the same can reasonably be inferred there from and if the contractors find any discrepancies therein he shall immediately and in writing, refer the same to the Employer/Architect whose decision shall be final and binding. The contractor shall provide himself for ground and fresh water for carrying out the works at his own cost. The Employer shall no account be responsible for the expenses incurred by the contractor for the hired ground or fresh water obtained from elsewhere.

The rates quoted against individual item will be inclusive of everything necessary to complete the said item of work with in the contemplation of the contract, and beyond the unit price no extra payment will be allowed for the incidental or contingent work, labour and / or material inclusive of all taxes and duties whatsoever except for the specific item, if any, stipulated in the tender documents.

The contractor shall at all times give access to workers employed by the Employer or any men employed on the works site and to the building and to provide such parties with proper sufficient and if required, special scaffolding, hoists and ladders and provide them with water and lighting and leaves or make any holes , grooves etc. in any work where directed by the Employer as may be required to enable such workmen to lay or fix pipes, electrical wiring, special fitting etc. The rates quoted rates of the tenderer shall accordingly include all these above mentioned contingent works.

### **13. TIME OF COMPLETION**

The entire work is to be completed in all respects within the stipulated period i.e **45 days** from the date of work order The work shall be deemed to be commenced with in Seven days from the date of acceptance letter of date of handing over of site, which ever is later. Time is the essence of the contract and shall be strictly observed by the contractor.

The work shall not be considered as complete until the Architect has certified in writing that this has been completed and the defects Liability Period shall commence from the date of such certificate.

During the period of construction the contractor shall maintain proportionate progress on the basis of a program chart submitted by the contractor immediately before commencement of work and agreed to by the employer/ Architects. Contractor should also include planning for procurement of scarce material well in advance and reflect the same in the program chart so that there is no delay in completion of the project.

### **14. LIQUIDATED DAMAGES**

Should the work be not completed to the satisfaction of the Employer/ Architects within the stipulated period, the contractor shall be bound to pay to the Employer a sum calculated as given below by way of liquidated damages and not as penalty during which the work remains uncommenced or unfurnished after the expiry of the completion date.

### **15. TOOLS, STORAGE OF MATERIALS, PROTECTIVE WORKS AND SITE OFFICE REQUIREMENTS**

The Contractor shall provide, fix up and maintain in an approved position proper office accommodation for the contractor's representative and staff which offices shall be open at all reasonable hours to receive instruction notices or communications and clear away on completion of the works and make good all work distributed. All drawing maintained on the site are to be carefully mounted on boards of appropriate size and covered with a coat of approved varnish. They are to be protected from ravages of termites, ants and other insects.

The contractor shall provide at his own cost all-artificial light required for the work and to be enable other contractor and sub-contractor to complete the work within the specified time.

The contractor shall provide a suitable temporary hut for the watchmen and clear away the same when no longer required and to provide all necessary attendance, light etc. required.

The contractor shall arrange for temporary latrines for the use of workers and field staff and keep the same in a clean and sanitary condition to the satisfaction of the public Health Authorities and shall cause latrines and soil to be cleared away whenever necessary and shall make good all the works distributed by the conveniences.

Every precaution shall be taken by the contractor to prevent the breeding of mosquitoes on the work during the construction, and all receptacles, cisterns, water tanks etc. used for the storage of the water must be suitably protected against breeding of mosquitoes. The contractor shall indemnify the Employer against any breach of rule in respect of ant-material measures.

The Contractor shall not fix or place any placards or advertisement of any description or permit the same to be fixed or placed in or upon any boarding, gantry, building structure other than those approved by the Employer.

**Protective Measures:** The contractor from time the time of being placed in possession of the site make suitable arrangement for watching, lighting and protecting the work, the site and surrounding property by day, by night, on Sunday and other holidays.

Contractor shall indemnify the Employer against any possible damage to the building, roads or members of the public in course of execution of the work.

The contractor shall provide necessary temporary enclosures, gates, entrance etc. for the protection of the work and materials and for altering and adopting the same as may be required and removing on completion of the work and making good all work distributed.

**Storage of Material:** The contractor shall provide and maintain proper sheds for the proper storage and adequate protection of the material etc. and the other work that may be executed on the site including the tools and materials and subcontractors and remove same on completion.

All measuring tapes shall be of steel and suitable scaffolding and ladders that may be required for safety taking measurement shall be supplied by the contractor.

The contractor should cover in his rates for making provisions for all reasonable facilities for the use of his **scaffolding**, tools and plant etc., by sub contractors for their work.

#### **16. NOTICE AND PATENTS OF APPROPRIATE AUTHORITY AND OWNERS**

The contractor shall confirm to the provision of any Acts of the Legislature relating to the work, and to the Regulations and Byelaws of any authorities, and/or any water, lighting and other companies and / or authorities with whose system the structures were proposed to have connection and shall before making any variation from the drawings or the specification that may be associated to so confirm, give the employer / Architect written notices specifying the variations proposed to be made and the reasons for making them and apply for instruction thereon. The Employer / Architect on receipt of such intimations shall give a decision within a reasonable time.

The contractor/s shall arrange to give the notices required for by the said Acts, Regulation or Bye Laws to be given to any authority, and to pay to such authority or to any public officer all fees that may be properly chargeable in respect of the work and lodge the receipt with the Employer.

The contractor shall indemnify the Employer against all claims in respect of patent rights, royalties, damages to buildings, roads or members of public in course of execution of work and shall defend all action arising from such claims and shall keep the Employer saved harmless and indemnified in all respect from such actions, costs and expenses.

#### **17. CLEARING SITE AND SETTING OUT WORKS.**

The site shown on the plan shall be cleared of all obstruction, loose stone and material rubbish of all kinds. All holes or hollows whether originally existing or produced by removal or loose stone or material shall be carefully filled up with earth well rammed and levelled off as directed at his own cost.

## **18. REMOVAL OF IMPROPER WORK**

The Employer shall during the progress of the work have power to order in writing from time to time the removal from the work within such reasonable time or times as may be specified in the order of any materials which in the opinion of the Employer / Architect are not in the accordance with specification or instruction, the substitution or proper re-execution of any work executed with materials or workmanship not in accordance with the drawing and specification or instructions. In case the contractor refuses to comply with the order, the Employer shall have the power to employ and pay other agencies to carry out the work and all expenses consequent thereon or incidental there to as certified by the Employer/ Architect shall be borne by the contractor or may be deducted from any money due to or that may become due to contractor. No certificate which may be given by the Architect shall relieve the contractor from his liability in respect of unsound work or bad materials.

## **19. CONTRACTOR'S EMPLOYEES**

No labour below the age of eighteen and who is not an Indian National shall be employed on the work

Any labour supplied by the contractor to be engaged on the work on day – work basis either wholly or partly under the direct order or the control of the Employer or his representative shall be deemed to be a person employed by the contractor.

The contractor shall comply with the provision of all the labour legislation including the requirement of

- a) The Payment of Wages Act.
- b) Employer's Liability Act.
- c) Workmen's Compensation Act.
- d) Contract Labour (Regulation & Abolition) Act, 1970 and Central Rules 1971.
- e) Apprentices Act 1961.
- f) Minimum Wages Act.
- g) Any other Act or enactment relating thereto and rules frames there under from time to time.

The contractor shall arrange to provide first-aid treatment to the labour engaged on the works. He shall within 24 hours of the occurrence of any accident at or about the site or in connection with the execution of the works, reports such accident to the Employer and also to the Competent Authority where such report is required by law.

## **20. DISMISSAL OF WORKMENS**

The contractor on the request of the Employer immediately dismiss from works any person employed thereon by him, who may in the opinion of the Employer be unsuitable or incompetent or who may misconduct himself. Such discharge shall not be the basis of any claim for compensation or damages against the Employer or any of their officers or employee.

## **21. ASSIGNMENT**

The whole of the works included in the contract shall be executed by the contractor and the contractor shall not directly or indirectly transfer, assign or underlet the contract or any part, share or interest therein nor, shall take a new partner, without written consent of the Employer and no subletting shall relive the contractor from the full and entire responsibility of the contract or from active superintendence of the work during their progress.

## **22. DAMAGE TO PERSON AND PROPERTY INSURANCE ETC**

The contractor shall be responsible for all injury to the work or workmen to persons, animals or thing and for all the damages to the structural and / or decorative part of property which may arise from the operations or neglect of himself or of any sub-contractor's employees, whether such injury or damage arise from carelessness, accident or any other cause whatsoever in the way connected with the carrying out of this contract. The clause shall be held to include inter-alia, any damage to buildings whether immediately adjacent or otherwise, and any damage to roads, streets, footpaths or ways as well as damages caused to the building and the works forming the subject of this contract by rain, wind or other inclemency of the weather. The contractor shall indemnify the employer and hold

harmless in respect of all and any expenses arising from any such injury or damages to persons or property as aforesaid and also in respect of any claim made in respect of injury or damage under any acts of compensation or damage consequent upon such claim.

The contractor shall reinstate all damage of every sort mentioned in this clause, so as to deliver the whole of the contract works complete and perfect in every respect and so as to make good or otherwise satisfy all claims for damages to the property or third parties.

The contractor shall effect the insurance necessary and indemnify the Employer entirely from all responsibility in this respect. The insurance must be placed with a company approved by the Employer and must be effected jointly in the name of the contractor and the Employer and the policy lodged with the letter.

The scope of insurance is to include damage or loss to the contract itself till this is made over in a complete state. Insurance is compulsory and must be effected from the very initial stage. The contractor shall also be responsible for anything which may be excluded from damages to any property arising out of incidents, negligence or defective carrying out of this contract.

The Employer shall be at liberty and hereby empowered to deduct the amount of any damages, compensation, costs, charges and expenses arising or accruing from or in respect of any such claim or damages from any sums due or to become due to the contractor.

### **23.INSURANCE**

Unless otherwise instructed the contractor shall insure the works and keep them insured until virtual completion of the contract against loss or damages by fire and/or earthquake, flood. The insurance must be placed with a company approved by the Employer and the contractor for such amount and for any further sum if called to do so by the employer, the premium of such further sum being allowed to the contractor as an authorized extra.

The contractor shall deposit the policy and receipt for premiums paid with the Employer within 21 (twenty one) days from the date of issue of work order unless otherwise instructed. In default of the contractor insuring as provided above, the Employer on his behalf may so insure and may deduct the premiums paid from any money due, or which may become due to the contractor. The contractor shall as soon as the claim under the policy is settled or the work reinstated by the Insurance Company should they elect to do so, proceed with due diligence with the completion of the works in the same manner as though the fire has not occurred and in all respects under the conditions of the contract. The contractor in the case of rebinding or reinstatement after fire shall be entitled to extension of time for completion as the Employer may deem fit.

### **24. ACCOUNTS RECEIPTS AND VOUCHERS**

The contractor shall, upon the request of the Employer furnish them with all the invoices, accounts, receipts and other vouchers that they may require in connection with the works under this contract. If the contractor shall use the material less than what he is required under the contract, the value of the difference in the quantity of the materials he was required to use and that he actually used shall be deducted from his dues. The decision of the Employer shall be final and binding on the contractor as to the amount of materials the contractor is required to use for any work under this contract.

Before taking any measurements of any work the Site Engineer or a subordinate deputed by him shall give reasonable notice to the contractor. If the contractor fails to attend at the measurements after such notice or fails to countersign or to record the difference within a week from the date of measurements in the manner required by the site Engineer then in any such event the measurements taken by the Site Engineer or by the subordinate deputed by him as the case may be is final and binding on the contractor and the contractor shall have no right to dispute the same.



## **25.PAYMENT**

All bills shall be prepared by the contractor in the form of prescribed by the Employer/ Architects. Normally one interim bill shall be paid subject to minimum value for interim certificate as stated in these documents. The bills in proper forms must be duly accompanied by detailed measurement in support of the quantities of work done and must show deduction for all previous payment, retention money etc.

The Architect shall issue certificate after due scrutiny of the Contractor's bill stating the amount due to the contractor from the Employer and the contractor shall be entitled to the payment thereof, within the period of honoring certificates named in these documents. In case of delay due to some reasons in the processing of such bills for payment, an ad-hoc advance of 75 % of the billed amount may be paid on the request of the contractor for the smooth progress of the work.

The amount stated in the interim certificate shall be total value of work properly executed and 75% of invoice value of materials brought to site for the permanent incorporation into the work up to the date of the bill less the amount to be retained by the Employer as retention money vide clause 12 of these conditions and less installments previously paid under the conditions, provided that certificates shall only include the value said materials and goods as and from such time as they are reasonably, properly and prematurely brought to or placed adjacent to the work and then only if adequately projected against weather or other casualties.

The Employer will deduct retention money as tender conditions already mentioned. The refund of retention money will be made as specified in the said tender condition.

If the Employer has supplied any material or goods to the Contractor, the cost of any such material or goods will be progressively deducted from the amount due to the contractor in accordance with the quantities consumed in the work.

All the interim payment shall be regarded as payment by way of advance against the final payment and only not as payment for work actually done and completed and shall not preclude the requiring of bad , unsound, and imperfect or unskilled work to be removed and taken away and reconstructed, or re-erected or be considered as an admission of the due performance of the contract, or any part thereof in any respect or the accruing of any claim, not shall, it conclude, determine or affect in any way the power of the Employer under these conditions or any of them as to the final settlement and adjustment of the accounts or otherwise or in any other way vary or affects the contracts. The final bill shall be submitted by the contractors within one month of the date fixed for completion of work or of the date of certificate of completion furnished by the Architect and payment shall be made within three months.

### **Final Payment**

The final bill shall be accompanied by a certificate of completion by the Architect. Payment of the final bill shall be made after deduction of Retention money as specified in Tender conditions, which sum shall be refunded after the completion of the Defects Liability period after receiving the Architect's certificate that the contractor has rectified all defects to the satisfaction of the Employer/ Architects. The acceptance of payment of the final bill by the contractor would indicate that he will have no further claim in respect of the work executed.

## **26.SUBSTITUTION**

Should the contractor desire to substitute any materials and workmanship, he/they must obtain the approval of the Architect in writing for any such substitution well in advance. Materials designated in this specification indefinitely by such terms as "equals" or "other approved" etc. specific approval of the Architect has to be obtained in writing.

## **27.PREPARATION OF WORKS CARRIED OUT FOR OCCUPATION AND USE ON COMPLETION**

The whole of the work will be thoroughly inspected by the contractor and deficiencies and defects put right. On completion of such inspection the contractor shall inform the Employer that he has completed the work and it is ready for inspection. On completion the contractor shall clean all windows and doors including the cleaning and oiling if necessary, of all hardware, inside and outside, all floors, staircase and every part of the building. He will leave the entire building neat and clean and ready for immediate occupation and to the satisfaction of the Employer.

### **28.CLEARING SITE ON COMPLETION**

On completion of the works the contractor shall clear away and remove from the site all constructional equipment's, plant and machinery, surplus materials, rubbish and temporary works of every kind and leave the whole of the site and the works clean and in workman like conditions to the satisfaction of the Employer/ Architects.

### **29.DEFECTS AFTER COMPLETION**

The contractor shall make good at his own cost and to satisfaction of the Employer/ the Architect, all defects, shrinkage settlement or other faults, which may appear within 12 months after completion of the work .In default, the employer may employ and pay other persons to amend and make good such damages, losses and expenses consequent there on or incidental there to shall be made good and borne by the contractor and such damages, losses and expenses shall be recoverable from him by the Employer or may be deducted by the Employer, in lieu of such amending and making good by the contractor, and deduct any money due to the contractor a sum equivalent to the cost of amending such work and in the event of the amount retained being insufficient, recover that balance from the contractor from the amount retained under clause no. together with any expenses the Employer may have incurred in connection therewith.

### **30.CONCEALED WORK**

The contractor shall give due notice to the Architect whenever the work is to be buried or hidden works, otherwise becoming inaccessible later on, in order that the work may be inspected and correct dimensions taken before such burial /hidden in default whereof the same shall, at the opinion of the Architect/ Employer be either open up for measurement at the contractor expenses or no payment may be made for such materials. Should any dispute or difference arise after the execution of any works as to measurement etc., or other matters which cannot be conveniently tested or checked, the notes of the Employer / Architects shall be accepted as correct and binding on the contractor.

### **31.ESCALATION**

The rate quoted shall be firm throughout the tenure of the contract(including extension of time, if any, granted) and will not be subject to any fluctuation due to increase in cost of materials, labour, sales tax, octroi, etc. No escalation shall be allowed on account of ANY reason whatsoever.

### **32.IDLE LABOUR**

Whatever the reasons may be no claim for idle labour, additional establishment cost of hire and labour charges of tools and plants would be entertained under any circumstances.

### **33. SUSPENSION**

If the contractor except on account of any legal restraint upon the Employer preventing the continuance of the work or in the opinion of the Employer shall neglect or fail to proceed with due diligence in the performance of his part of the contract or if he shall more than once make default, the Employer shall have the power to give notice in writing to the contractor requiring the work be proceeded within a reasonable manner and reasonable dispatch, such notice purport to be a notice under this clause.

After such notice shall have been given the contractor shall not be at liberty to remove from the site of the works or from any ground contiguous thereto any plant or material to subsist from the date of such notice being given until the notice shall have been complied with. If the contractor fails to start the work within seven days after such notice has been given proceed with the works as therein prescribed, the Employer may proceed for termination of contract as per the tender conditions.

### **34. TERMINATION OF CONTRACT BY EMPLOYER**

If the contractor being a company go into liquidation whether voluntary or compulsory or being a firm shall be dissolved or being an individual shall be adjudicated insolvent or shall make an assignment or a composition for the benefit of the greater part, in number of amount of his creditors or shall enter into a Deed or arrangement with his creditors or if the Official Assignee in insolvency, or the Receiver of the contractor in insolvency shall repudiate the contract, or if a receiver of the contractor's firm appointed by the court shall be unable, within fourteen days after notice to him requiring him to do so, to show to the reasonable satisfaction of the employer that he is able to carry out and fulfill the contract, and if so required by the employer to give reasonable security therefore, or if the contractor shall suffer execution to be issued, or shall sufferance payment under this contract to be attached by or on behalf of and of creditors of the contractor, or shall assign, charges or encumber this contract or any payments due or which may become due to the contractor, there under, or shall neglect or fail to observe and perform all or any of the acts matters of things by this contract to be observed and performed by the contractors within three clear days after the notice shall have been given to the contractor in manner hereinafter mentioned requiring the contractor to observe or perform the same or shall use improper materials or workmanship in carrying on the work , or shall in the opinion of the Employer not exercise such due diligence and make such due progress as would enable the wok to be completed within due time agreed upon, and shall fail to proceed to the satisfaction of the Employer after three clear days notice requiring the contractor so to do shall have been given to contractor as hereinafter mentioned, or shall abandon the contract , then and in any of the said cases, the Bank may notwithstanding previous waiver determine the contract by a notice in writing to the effect as hereinafter mentioned, but without thereby effecting the powers of the Employer of the obligations and liabilities of the contractor the whole of which shall continue in force as fully as if the contract, had not been so determined and as if the works subsequently executed had been executed by the or on behalf of the contractor (without thereby creating any trust in favour of contractor) further the Employer or his agent , or servants , may enter upon and take the possession of the work and all plants, tools, scaffoldings, shades, machinery, steams and other power, utensils and material laying upon premises or the adjoining lands or roads and sell the same as his own property or may employ the same by means of his own servants and workmen in carrying on and completing the work or by employing any other contractor or other person or person to complete the work and contractor shall not in any way interrupt or do any act, matter of thing to prevent or hinder such other contractor or other persons or persons employed from completing and finishing or using the materials and plants for the work when the work shall be completed , or as soon thereafter as conveniently may be, the Employer shall give notice in writing to the contractor to remove this surplus materials and plant and should the contractor fail to do so within the a period of 14 days after receipt by him the Employer may sell the same by public auction and shall give credit to the contractor for the amount so realized. Any expenses or losses incurred by Employer in getting the work carried out by other contractor shall be adjusted against the amount payable to the contractor by way of selling his tools and plants or due on account of work carried out by the contractor prior to engaging other contractors or against the security deposits.

### **35. ARBITRATION**

All disputes or differences of any kind whatsoever which shall at any time arise between the parties hereto touching or concerning the works or the execution or maintenance thereof this contract or the construction remaining operation or effect thereof or to the rights or liabilities of the parties or arising out of or in relation thereto whether during or after determination foreclosure or branch of the contract (Other than those in respect of which the decision of any person is by contract expressed to be final and binding) shall after written notice by either party to the contract to the either of them and to the Employer hereinafter mentioned be referred for adjudication to a sole arbitrator to be appointed as hereinafter provided.

For the purpose of appointing the sole arbitrator referred to above, the Employer will send within thirty days of receipt of the notice, to the contractor a panel of three of persons who shall be presently unconnected with the organization for which the work is executed.

The contractor shall on receipt of the names as aforesaid, select anyone of the persons name to be appointed as a sole Arbitrator and communicate his names to the Employer within thirty days of receipt of the names. The Employer shall thereupon without any delay appoint the said person as the Sole arbitrator. If the contractor fails to

communicate such selection as provided above within the specified period, the competent authority shall make the selection and appoint the selected person as a Sole Arbitrator.

If the Arbitrator so appointed is unable or unwilling to Act or resign his appointment or vacates his office due to any reasons whatsoever another Sole Arbitrator shall be appointed as aforesaid.

The work under contract shall, however, continue during the arbitration proceedings and no payment due or payable to the contractor shall be withheld on account of such proceedings.

The Arbitrator shall be deemed to have entered on the reference on the date he issued notice to both the parties fixing the date of the first hearing.

The Arbitrator may from time to time, with the consent of the parties, enlarge the time for making and publishing the award.

The Arbitrator shall give a separate award in respect of each dispute or difference referred to him. The arbitrator shall decide each dispute in accordance with the terms of the contract and give a reasoned award. The venue of arbitration shall be such place as may be fixed by the Arbitrator in his sole direction.

The fees, if any, of the Arbitrator shall, if required to be paid before the award is made and published, be paid half and half by each of the parties. The cost of the reference and of the award including the fees, if any, of the Arbitrator who may direct to and by whom and in what manner, such cost or any part thereof shall be paid and may fix or settle and amount of costs to be so paid.

The award of the Arbitrator shall be final and binding on both the parties.

Subject to aforesaid the provision of the Arbitration Act 1992 or any statutory modification or re-enactment thereof and the rules made there under, and for the time being in force, shall apply to the arbitration proceeding under this clause.

The Employer and the contractor hereby also agree that arbitration under clause shall be a condition precedent to any right to action under the contract with regards to the matter hereby expressly agreed to be so referred to arbitration.

**Signature of Contractor/  
Tenderer with seal**

## **GENERAL SPECIFICATIONS FOR WORKMANSHIP AND MATERIALS: -**

**The Contractor agrees to execute the work as below: -**

- 1) The workmanship has to be of the best quality to the satisfaction of the Bank. The entire premises shall be thoroughly cleaned before the job is handed over.
- 2) The exposed edges of the plywood shall be properly covered with laminate or lipping and no edges shall be left unlippped.
- 3) All the joinery shall be neat and joinery of plywood shall be “dove-tailed” type and always fixed with proper screws and adhesives ( Fevicol/ Falcofix or Equivalent) and no nails shall be used for joinery.
- 4) For all the woodwork the wood surfaces shall be made absolutely “smooth and even” by planing thoroughly & baitha.
- 5) Pressing of laminates shall be in a workman like manner ensuring **no air pockets** with clean edges.
- 6) All the details on the woodwork like grooves and moulding etc shall be neat and clean and in proper line and level.
- 7) For all polishing works, the surfaces shall be prepared absolutely smooth and the finishing done in a workman like manner.
- 8) Plywood used shall be of MR Grade of specified make, ISI marked Confirming to IS -303 and shall be got approved before use. **(1st quality Greenply(Green MR)/ Century ply (Century Win)/ Kitply (Swastik Plus) as approved by the Bank.**
- 9) All teakwood exposed shall be of good quality “C.P.” TEAK WOOD and shall be got approved before use. The basic rate of C.P. teakwood Rs.4500/cu.ft. inclusive of all Taxes.
- 10) Laminates shall be of standard quality **(1.0 mm thick) (Royal Touch: Cedar -968, Palm Beech -948 or Sunmica / Formica : Cedar -21, Palm Beech -72 or Merinolam )** as per competent authority or as approved by the Bank.
- 11) All glasses shall be of 5, 10 & 12mm thick. All clear glasses shall be of Modi float / Asahi float /St.Globain float glass only. All exposed edges of glass shall be Machine polished, bevelled & smooth as per the quality requirements of the Bank.
- 12) All fittings and fixtures shall be of best quality, heavy type brass oxidized or chromium plated as per Bank requirements and specifications. All storage locks, tower bolts, hinges, ball catches, telescopic sliding channels (Earl-Behari/ Godrej/ Hettich make) and handles as per approval of the Bank.
- 13) Door fittings shall include handles, heavy duty brass hinges, with night latch (wherever mentioned) / Aldrop / mortise locks directed (in brass chrome or oxidized,) door stopper and shall be supplied and fixed by the contractor. All above hardware shall be approved by the Bank before use.
- 14) All exposed T.W. members shall be finished with wood polish.
- 15) **All Drawer sliders / Keyboard sliders shall be telescopic channels / sliders only.**
- 16) All Concealed locks to the doors shall be of Godrej make only

**The material shall be first approved from the Bank’s Architect / Bank’s Competent Authorities.**

**Signature of Contractor/  
Tenderer with seal**

**Chairman  
Maharashtra Gramin Bank  
Head office, Aurangabad (M.S.)**

**APPROVED MAKE OF MATERIALS**

<b>SR. NO.</b>	<b>ITEM / MATERIAL</b>	<b>MAKE</b>
1.	Particle Board	-----
2.	Antitermite / Fire retardant Paint	-----
3.	False Ceiling	Amstrong make only subject to prior approval from Bank's Competent Authorities.
4.	Oil Bound Distemper / Acrylic Emulsion	Asian, Dulux, Berger
5.	Laminate	(Royal Touch: Cedar -968, Palm Beech -948 or Sunmica / Formica : Cedar -21, Palm Beech -72 or Merinolam )
6.	Teak Wood	C.P. Teakwood
7.	Foam	-----
8.	Hardware	-----
9.	Tile	-----
10.	Leatherite	-----
.	Glass	Modi float / Asahi / St. Gobain
12.	Ply	(1st quality Greenply(Green MR)/ Century ply (Century Win)/ Kitply (Swastik Plus) )
13.	Vinyle Film	-----
14.	Board	-----
15.	Carpet	-----
16.	External Cement Paint	Weather Shield (Dulux) or equivalent subject to prior approval from Bank's Competent Authorities.
17.	Cement	-----
18.	GI Pipe	-----
19.	Paint	Dulux / Berger / Asian Synthetic Enamel Paint First Quality
20.	CP Fitting	-----



21.	Ceramic Fitting	----
22.	Kitchen Sink	-----
23.	Vitrified Tiles	-----
24.	Aluminium Section	<b>Jindal</b> ISI including for partition framework and other framework
25.	Flush Door Shutter	-----
26.	Glue	-----
27.	Gipboard False Ceiling	Manufactured by Gypsum india Pvt. Ltd make or equivalent subject to prior approval from Bank's Competent Authorities.
28.	Venetian Blinds	Vista levolor make subject to prior approval from Bank's Competent Authorities.
29.	Door Closer	Ozone/ Dorma/ Godrej make heavy duty
30.	Floor Spring	Godrej make D100 Floor Spring (100 Kg.) Ozone/ Dorma make only
31.	Melamine Polish	As per Specifications of tender
32.	Wax polish	-----
33.	U – Foam	-----
34.	Fabric	-----
35.	Locks / Concealed locks with Handle for Door Shutter	Godrej make only
36.	Metallic Laminate	-----

**The material to be used has to be first got approved before execution of work from the Bank's Architect / Bank's Competent Authorities.**

**Signature of Contractor/  
Tenderer with seal**

**Chairman  
Maharashtra Gramin Bank  
Head office, Aurangabad (M.S.)**



**MAHARASHTRA GRAMIN BANK**

(A Scheduled Bank established by Govt. of India.)  
Sponsor Bank : Bank of Maharashtra

**IMPORTANT:**

**THE CONTRACTORS SHALL QUOTE THE EXACT WORKING RATES OF ITEMS & NO REBATE /DISCOUNT IN PERCENTAGES SHALL BE CONSIDERED AS IT IS AN ITEM RATE TENDER WITH THE PRICE BID, THE RATES QUOTED WILL ONLY BE TAKEN INTO ACCOUNT. HOWEVER DURING THE PERIOD OF NEGOTIATION IF ANY AS THE AUTHORITIES MAY DEEM FIT TO SHALL BE CONSIDERED DURING THE PROCESS OF NEGOTIATIONS WHILE ACCEPTANCE OF THE TENDER.**



**TENDER OF INTERIOR FURNISHING WORKS FOR MAHARASHTRA GRAMIN BANK,  
NEW PREMISES, FIRST FLOOR, REGIONAL OFFICE, PUNE, DISTT. PUNE (M.S.).**

**TOTAL OF ANNEXURE Rs. \_\_\_\_\_  
“INTERIOR FURNISHING WORKS”**

**RUPEES \_\_\_\_\_**

**ADD CGST @ 9.00% Rs. \_\_\_\_\_**

**ADD SGST @ 9.00% Rs. \_\_\_\_\_**

**GRAND TOTAL Rs. \_\_\_\_\_**

**RUPEES \_\_\_\_\_**

**Signature of Contractor/  
Tenderer with seal**

**Chairman**  
Maharashtra Gramin Bank,  
Head office, Aurangabad. (M.S.)

**TENDER**  
**INTERIOR FURNISHING WORKS**

**NAME OF WORK: TENDER OF INTERIOR FURNISHING WORKS TO BE EXECUTED FOR MAHARASHTRA GRAMIN BANK, NEW PREMISES, 1<sup>st</sup> FLOOR, REGIONAL OFFICE PUNE (M.S.)**

**NAME OF CONTRACTOR \_\_\_\_\_**

Item No.	Description	Quantity	Rate	Per	Amount
			Rs. Ps.		Rs. Ps.
1	<p><b>FALSE CEILING-</b> <b>MODULAR FALSE CEILING (600 X 600 mm)-</b> Providing and fixing of Mineral Fiber Board Acoustical Suspended Ceiling System with <b>Dune RH99 (600X600mm)</b> Microlook edge tiles 16mm thick placed on <b>Silhoute</b> (15mm thick) grid of required size To Place the Tiles on Exposed <b>Silhoute</b> grid of Armstrong make only. (as approved by Bank's Architect/ competent authorities)The tiles should have Humidity Resistance (RH) of 99%, NRC 0.7, Light Reflectance 90%, Thermal Conductivity k=0.052-0.057 w/m K, Colour White, Fire Performance UK Class 0/ Class 1 (BS 476 pt – 6&amp;7) in module size of 600x600x16mm, suitable for Green Building application, with Recycled content of 32%. The items includes all materials, tiles, fixing, finishing etc. Complete.</p>	100.00		Sqmt	
2	<p><b>FULLY GLAZED ENTRANCE DOOR</b> Providing &amp; fixing fully glazed Partition with Glazed door at the entrance facade as per design, drawing and as directed by architect made out of 12 mm thick Toughened safety glass (modi/Asahi/St.Gobain ) with diamond edge polish for exposed edges &amp; 2.5" round cut in the glass as per design Glasses should be fixed in S.S. finished D-brackets etc. with s.s. Metal patch fittings at Top/Bottom /Corner (Dorma /polo Make or equivalent as approved by Bank authorities for door shutter and partition for Glass partition : Glass panels can be Bolted together with stainless steel Stub/Stud post which are fixed into concrete/ paneling works through core drill holes or supported by stainless steel clamp fixing to vertical posts on each sides as per requirement and as directed by Architect, with necessary bevelling etc. complete fixed on floor spring of Ozone/Dorma/Godrej Make <b>(I.S.I mark, Heavy duty, Item taken Separately)</b>. The shutters shall have SS Handle 600 mm on both sides of approved make, with erection, fixing, finishing etc. complete and as directed by Architect. The entire glass partition/door is to be finished with one way opaque film or as per banks requirement or as directed by architect .</p>	7.50		Sqmt.	
				C/F	

**TENDER**  
**INTERIOR FURNISHING WORKS**

**NAME OF WORK: TENDER OF INTERIOR FURNISHING WORKS TO BE EXECUTED FOR MAHARASHTRA GRAMIN BANK, NEW PREMISES, 1<sup>st</sup> FLOOR, REGIONAL OFFICE PUNE (M.S.)**

**NAME OF CONTRACTOR** \_\_\_\_\_

Item No.	Description	Quantity	Rate	Per	Amount
			Rs. Ps.		Rs. Ps.
				B/F	
3	<p><b>[RM CABIN PARTITION]</b> Providing &amp; Fixing Full height Fully Glazed/partly glazed And Partly panelled partition/Fully Panelled Partions at Required positions of required height (2.15 or above ) with door as per drawing, design and as directed by the Architect. (Glazed portion at required places) made out of framework of standard Aluminium rectangular section (50 X 50mm X 1mmThickness) of size 600 X400 mm c/c covered <b>with 12 mm thick</b> ply of MR Grade of ISI Mark confirming to IS-303 <b>First Quality</b> (Century- (Century Win), Kitply- (Swastik plus)/(Greenply(Green MR)- 1<sup>st</sup> quality) on both sides &amp; finished with 1.00mm thk Laminate (Merinolam/Sunmica/ Formica/Royal Touch) of approved shade and design on both side of partition. The glazed portion shall be 10 mm thick clear float glass with itching as per design &amp; drawing &amp; as directed. fixed with T.W. moulding beading of required size on inner side of the partition. All the exposed faces of Teak Wood/ T.W. beading shall be finished with wooden polish of approved shade and as directed by the Architect. The overall thickness of the partition shall be 50mm. The door shall be made out of framework of standard Aluminium rectangular section (50X50mmX1mmThickness) of Required size, covered with 12 mm thick ply of MR grade of ISI mark confirming to IS-303 <b>First Quality</b> (Century- (Century Win) Kitply- (Swastik plus) / (Greenply(Green MR)1<sup>st</sup> quality) on both sides &amp; finished with 1.00mm thick approved <b>laminat</b>e (Merinolam/Sunmica/ Formica/Royal Touch) as directed by Architect. The top rail , And Styles shall have 150 mm Thickness and Bottom rail shall have 350mm thickness (height) while other part shall be fully glazed with 10 mm thick glass or as directed As per site conditions with necessary etching &amp; with T.W. Beading of size 25x12mm.The shutter shall be fixed on floor spring of Ozone/Dorma/Godrej <b>Make (I.S.I mark, Heavy duty, Item taken Separately).</b> The shutters shall have concealed godrej lock make /mortise lock /Aldrops as per requirement, Brass Tower Bolt 150mm long, S.S./</p>	30.00		Sqmt.	
				C/F	

**TENDER**

**INTERIOR FURNISHING WORKS**

**NAME OF WORK: TENDER OF INTERIOR FURNISHING WORKS TO BE EXECUTED FOR MAHARASHTRA GRAMIN BANK, NEW PREMISES, 1<sup>st</sup> FLOOR, REGIONAL OFFICE PUNE (M.S.)**

**NAME OF CONTRACTOR \_\_\_\_\_**

Item No.	Description	Quantity	Rate	Per	Amount
			Rs. Ps.		Rs. Ps.
				B/F	
	Brass Handle 300 mm, Door Stopper with Erection, finishing etc. complete and as directed by Architect. The glazed portion shall be 10 mm thick clear float glass with itching as per design & drawing & as directed. fixed with T.W. moulding beading of required size on inner side of the partition. All the exposed faces of Teak Wood/ and T.W. beading shall be finished with wooden polish of approved shade and as directed by the Architect. The overall thickness of the partition including door shall be 75 mm. or as required and as directed .				
4	<b><u>EXECUTIVE TABLE</u></b> Providing and fixing Tables of required sizes as per drawing, design & as directed with one drawer & below it one shutter with mid shelf , Footrest & CPU arrangement made out of 18mm thick ply of MR Grade of ISI mark confirming to IS-303 <b>First Quality</b> (Century- (Century Win) Kitply- (Swastik plus) / (Greenply (Green MR)) at required position as directed by Architect or as per Standard design of bank or as required And finished with 1.0mm thick Laminate (Merinolam/Sunmica/ Formica/Royal Touch) on exposed outer surfaces and <b>Glass top of 12mm thk.</b> (Modi float/Asahi/ St. Gobain) with bevelled Etching as per design, drawing and as directed by the Architect. One key board and sliding writing top arrangement is to be made in the table and necessary arrangement for computer casing if required inclusive of Brass fittings, hinges, Godrej locks (concealed) to all drawers, Powder coated handle, Ebco drawers sliders (Telescopic) and Keyboard channels, handles etc.complete. All internal exposed surfaces shall be finished in 0.8 mm thick laminate & all inside hidden faces except the bottom of the drawer shall be finished with French sprit polish in two or more coats with finishing, carting, erection including T.W. Beading required for table etc. complete. The table top shall be 38 mm thick minimum at the front	3.80		Rmt.	
				C/F	

**TENDER**  
**INTERIOR FURNISHING WORKS**

**NAME OF WORK: TENDER OF INTERIOR FURNISHING WORKS TO BE EXECUTED FOR MAHARASHTRA GRAMIN BANK, NEW PREMISES, 1<sup>st</sup> FLOOR, REGIONAL OFFICE PUNE (M.S.)**

**NAME OF CONTRACTOR \_\_\_\_\_**

Item No.	Description	Quantity	Rate	Per	Amount
			Rs. Ps.		Rs. Ps.
				B/F	
	face finished with T.W. Moulding/member half round made out of 50 mm thick wooden member as per drawing, design wherever required & as directed by the Bank's Architect etc. Complete..				
5	<b><u>EXECUTIVE TABLE SIDE RACKS</u></b> Providing and fixing Side tables /racks of required size as per design, drawing and as directed of I.S.I. Mark confirming to IS-303 <b>First Quality</b> (Century- (Century Win) Kitply- (Swastik plus) (Greenply(Green MR)- 1 <sup>st</sup> quality) and finished with 1.0 mm thick laminate (Merinolam/Sunmica/ Formica/ Royal Touch) sheet of approved shade by Architect with provision of one drawers below and storage cabinet with openable shutters, powder coated handle, Ebco drawers sliders (telescopic), etc complete as directed. All internal exposed surfaces shall be finished in 0.8 mm thick laminate and all inside hidden faces except the bottom of the drawer shall be finished with french spirit polish in three coats with finishing, carting, erection and including T.W. Beading required for table etc. complete. All skirtings of the side racks, tables shall be finished with 80x25 mm teak wood mouldings as per design & as directed etc. complete.	3.00		Rmt.	
6	<b><u>OFFICER TABLE – with one drawer and Shutter</u></b> Providing and fixing officer Table of required size with 50 mm thick in front apron finished with T.W. Member made out of – 40 to 50 mm thick Teak Wood section to match with the top external face as required table top with one drawer and below it one shutter with mid shelf ,footrest & CPU arrangement made out of 18mm thick ply of MR Grade of ISI mark confirming to IS-303 <b>First Quality</b> (Century- (Century Win) Kitply- (Swastik plus) / (Greenply(Green MR) finished with 1.0mm thick Laminate (Merinolam/Sunmica/ Formica/Royal Touch) on exposed outer surfaces and <b>Glass top of 12mm thk.</b> (Modi float/Asahi/ St. Gobain) with beveled Etching as per design, drawing and as directed by	13.00		Rmt.	
				C/F	

**TENDER**  
**INTERIOR FURNISHING WORKS**

**NAME OF WORK: TENDER OF INTERIOR FURNISHING WORKS TO BE EXECUTED FOR MAHARASHTRA GRAMIN BANK, NEW PREMISES, 1<sup>st</sup> FLOOR, REGIONAL OFFICE PUNE (M.S.)**

**NAME OF CONTRACTOR \_\_\_\_\_**

Item No.	Description	Quantity	Rate	Per	Amount
			Rs. Ps.		Rs. Ps.
				B/F	
	the Architect. One key board arrangement is to be made in the table and necessary arrangement for computer casing if required inclusive of Brass fittings, hinges, Godrej locks (concealed) to all drawers Powder coated handle, Ebco drawers sliders (Telescopic) And Keyboard channels, handles etc. complete. All internal exposed surfaces shall be finished in 0.8 mm thick laminate & all inside hidden faces except the bottom of the drawer shall be finished with French sprit polish in two or more coats with finishing, carting, erection including T.W. Beading required for table etc. complete. All skirtings of the tables shall be finished with 80x25 mm teak wood mouldings as per design & as directed etc. Complete.				
7	<b>OFFICER'S TABLE Without Drawer</b> Providing – required nos. of officers table of required sizes as per design and made out of 18 mm thick MR Grade ply of I.S.I. Mark confirming to IS-303 <b>First Quality</b> (Century- (Century Win) Kitply- (Swastik plus) / (Greenply(Green MR) & finished with 1.0mm thick laminate in multicolor (Merinolam/Sunmica/ Formica/Royal Touch) as per standard design of Bank or as required & as directed by the Architect. Arrangement for CPU and keyboard is to be made as per design and as directed with necessary arrangement for computer casing required inclusive of Brass fittings, hinges & Keyboard Sliding channels (telescopic), handles etc. Complete. Internal exposed surfaces & all inside hidden faces shall be finished in in 0.8mm thick laminate including drawers inside, except the bottom of the drawer shall be finished with french spirit polish in three coats with finishing, carting, erection and including T.W. Beading required for table etc. complete. <b>The table shall be provided with 12 mm thick glass top with all edges machine polished.</b>	9.00		Rmt.	
				C/F	

**TENDER**  
**INTERIOR FURNISHING WORKS**

**NAME OF WORK: TENDER OF INTERIOR FURNISHING WORKS TO BE EXECUTED FOR MAHARASHTRA GRAMIN BANK, NEW PREMISES, 1<sup>st</sup> FLOOR, REGIONAL OFFICE PUNE (M.S.)**

**NAME OF CONTRACTOR \_\_\_\_\_**

Item No.	Description	Quantity	Rate	Per	Amount
			Rs. Ps.		Rs. Ps.
				B/F	
8	<p><b><u>OFFICER'S TABLE'S SIDE RACK</u></b> Providing and fixing Side table /rack of required size &amp; in required nos. in Officer Cubical /cabin as per design, drawing and as directed of I.S.I. Mark confirming to IS-303 <b>First Quality</b> (Century- (Century Win) Kitply- (Swastik plus) / (Greenply(Green MR) and finished with 1.0 mm thick laminate (Merinolam/Sunmica/ Formica/Royal Touch) sheet of approved shade by Architect with provision of two drawers &amp; below it storage cabinet with openable shutters &amp; midshelf, powder coated handle, Ebco drawers sliders (telescopic), etc complete as directed. All internal exposed surfaces shall be finished in 0.8 mm thick laminate and all inside hidden faces except the bottom of the drawer shall be finished with french spirit polish in three coats with finishing, carting, erection and including T.W. Beading required for table etc. complete. All skirtings of the side racks, tables shall be finished with 80x25 mm teak wood mouldings as per design &amp; as directed etc. complete.</p>	5.50		Rmt.	
9	<p><b><u>PARTLY GLAZED AND PARTLY PANELLED PARTITION (Low Height)</u></b> Providing &amp; Fixing partly glazed &amp; partly panelled partition at required position as per drawing and as directed by the Architect.(Glazed portion at required places) as per design and drawing made out of standard Aluminium rectangular section (44 X 44 X 1 mm thickness) of size 600 X 400 mm c/c covered <b>with 8 mm thk ply</b> of MR Grade of ISI mark confirming to IS -303 <b>First Quality</b> (Century- (Century Win) Kitply- (Swastik plus) /(Greenply (Green MR) 1<sup>st</sup> quality) on both sides &amp; finished with 1.00mm thk laminate (Merinolam/Sunmica/ Formica /Royal Touch) of approved shade and design on both side of partition. The glazed portion shall be 10 mm thick clear float glass fixed with T.W. Moulding Beading of required size on inner side of the partition. All the exposed faces of T.W. wood and T.W.beading shall be finished with wooden polish of approved shade and as directed by the Architect. <b>The overall thickness of the partition shall be 60 mm. The overall height of partition shall be 1.45 Mts</b></p>	27.00		Sqmt.	
				C/F	

**TENDER**  
**INTERIOR FURNISHING WORKS**

**NAME OF WORK: TENDER OF INTERIOR FURNISHING WORKS TO BE EXECUTED FOR MAHARASHTRA GRAMIN BANK, NEW PREMISES, 1<sup>st</sup> FLOOR, REGIONAL OFFICE PUNE (M.S.)**

**NAME OF CONTRACTOR** \_\_\_\_\_

Item No.	Description	Quantity	Rate	Per	Amount
			Rs. Ps.		Rs. Ps.
				B/F	
10	<p><b><u>FULL HEIGHT FULLY PANELLED / PARTLY GLAZED PARTLY PANELLED PARTITION</u></b> Providing &amp; Fixing full height Fully paneled or Partly Glazed Partly Panelled Partition at required positions as per Drawing of required height ( 2.45 Mts or above as directed ) as per drawing and as directed by the Architect (Glazed portion at required places) as per Design and drawing made out of Framework of standard Aluminium rectangular section (50 X 50 X 1mm thickness) of size 600 X 400 mm c/c covered with <b>12mm thick ply</b> of MR Grade of ISI Mark confirming to IS-303 <b>First Quality</b> (Century- (Century Win), Kitply- (Swastik plus)//Greenply-Green MR)- 1<sup>st</sup> quality) on both sides &amp; finished with 1.00mm thk Laminate (Merinolam/Sunmica/ Formica/Royal Touch) of approved shade and design on both side of partition as directed fixed with T.W. moulded beading of required size on inner side of the partition. All the exposed faces of T.W. wood and T.W. beading shall be finished with wooden polish of approved shade and as directed by the Architect. The overall thickness of the partition shall be 75mm.</p>	127.00		Sqmt.	
11	<p><b><u>CABIN DOORS</u></b> Providing and fixing partly glazed and partly panelled door (overall thickness min. 50mm shutter) at required positions and as directed the door shall be made out of framework of standard Aluminium rectangular section (40X40mmX1mmThickness) of Required size, Covered with 8mm thick ply of MR grade of ISI mark confirming to IS-303 1st quality Greenply (Green MR) /Century Ply (Century Win)/ Kitply(Swastik plus)/ on both sides &amp; finishedwith 1.00mm thick approved <b>laminat</b>e (Merino/ Sunmica /Formica / Royal Touch or equivalent.) as directed by Architect. The Upper portion of the shutter shall have 5mm thick glass panel above 900 mm or as directed from floor level with necessary itching &amp; with T.W. Beading of size 25x12mm.The shutter have Brass Hinges, Night latch of Godrej Make /Aldrops as per requirement, Brass Tower Bolt 150mm long, Brass Handle 100 mm, Door Stopper with Erection, finishing etc. complete and as directed by Architect.</p>	15.00		Sqmt.	
				C/F	



**TENDER****INTERIOR FURNISHING WORKS**

**NAME OF WORK: TENDER OF INTERIOR FURNISHING WORKS TO BE EXECUTED FOR MAHARASHTRA GRAMIN BANK, NEW PREMISES, 1<sup>st</sup> FLOOR, REGIONAL OFFICE PUNE (M.S.)**

**NAME OF CONTRACTOR** \_\_\_\_\_

Item No.	Description	Quantity	Rate	Per	Amount
			Rs. Ps.		Rs. Ps.
				B/F	
12	<b>DOOR CLOSER</b> Providing & fixing door closer to doors of Dorma make /Godrej heavy only, inclusive of fixing, finishing etc. complete.	7.00		Nos.	
13	<b>FLOOR SPRING</b> Providing & fixing floor spring to doors of Godrej make D100 floor spring (100kg) or equivalent Ozone/Dorma make of I.S.I mark.	4.00		Nos.	
14	<b>STORAGE RACK (Low Height)</b> Providing & fixing storage rack of required height (upto 1.20 mt or as required) at required position made out of 18mm thick MR Grade ply of I.S.I. Mark confirming to I.S. 303 <b>First Quality</b> (Century- (Century Win), Kitply- (Swastik plus)/ (Greenply(Green MR)- 1 <sup>st</sup> quality) finished with 1.0mm thick Laminate (Merinolam/ /Sunmica/ Formica/Royal Touch) as per drawing and as directed by Architect. The frame shall be Made out of 18mm thk. MR Grade ply confirming to I.S. 303 <b>First Quality</b> (Century- (Century Win), Kitply- (Swastik plus)/ (Greenply(Green MR)- 1 <sup>st</sup> quality) finished with 1.0mm thick Laminate (Merinolam/ /Sunmica/ Formica/Royal Touch) as per drawing and as directed by Architect. The shutters shall have <b>overall thickness of 25 mm</b> made out of 12mm thick MR grade ply ISI mark confirming to I.S.I 303 <b>First Quality</b> (Century- (Century Win)/ Kitply- (Swastik plus) / (Greenply(Green MR) Shutter Framework shall be made out of Size 75mmx12mm and 6mm thk ply pressed on Both sides to have thickness of 25 mm with T.W. Beading on edges of shutters finished with 1.0 mm thk Laminate (Merinolam//Sunmica/ Formica/Royal Touch) in multicolour as per design and drawing and of approved shade and colour on <b>all the external surfaces i.e front portlon, rear portion &amp; all sides of storage rack</b> . All internal shelves made out of 18 mm thk MR Grade ply and finished with 0.8 mm thick laminate on top side & including all internal surfaces inside but excluding hidden faces. Shutters should have Brass hinges with ball catchers, magnetic catchers, brass screws, all internal surfaces shall be finished with 0.8 mm thick laminate and wood surfaces, T.W. Beadings, lippings etc. finished with polish complete. <b>Note: Laminate 1.0 mm thick shall fixed on all the external surfaces i.e front portion, rear portion &amp; all sides of storage rack.</b>	31.00		Sqmt.	
				C/F	

**TENDER****INTERIOR FURNISHING WORKS**

**NAME OF WORK: TENDER OF INTERIOR FURNISHING WORKS TO BE EXECUTED FOR MAHARASHTRA GRAMIN BANK, NEW PREMISES, 1<sup>st</sup> FLOOR, REGIONAL OFFICE PUNE (M.S.)**

**NAME OF CONTRACTOR \_\_\_\_\_**

Item No.	Description	Quantity	Rate	Per	Amount
			Rs. Ps.		Rs. Ps.
				B/F	
15	<p><b>STORAGE RACK (Full Height)</b>            Providing &amp; fixing storage rack of required height (upto 2.25 mt or as required) at required position made out of 18mm thick MR Grade ply of I.S.I. Mark confirming to I.S. 303 <b>First Quality</b> (Century- (Century Win), Kitply- (Swastik plus)/ (Greenply(Green MR)- 1<sup>st</sup> quality) finished with 1.0mm thick Laminate (Merinolam/ /Sunmica/ Formica/Royal Touch) as per drawing and as directed by Architect. The frame shall be Made out of 18mm thk. MR Grade ply confirming to I.S. 303 <b>First Quality</b> (Century- (Century Win), Kitply- (Swastik plus)/ (Greenply(Green MR)- 1<sup>st</sup> quality) finished with 1.0mm thick Laminate (Merinolam/ /Sunmica/ Formica/Royal Touch) as per drawing and as directed by Architect. The shutters shall have <b>overall thickness of 25 mm</b> made out of 12mm thick MR grade ply ISI mark confirming to I.S.I 303 <b>First Quality</b> (Century- (Century Win)/ Kitply- (Swastik plus) / (Greenply(Green MR) Shutter Framework shall be made out of Size 75mmx12mm and 6mm thk ply pressed on Both sides to have thickness of 25 mm with T.W. Beading on edges of shutters finished with 1.0 mm thk Laminate (Merinolam//Sunmica/ Formica/Royal Touch) in multicolour as per design and drawing and of approved shade and colour on <b>all the external surfaces i.e front portion, rear portion &amp; all sides of storage rack.</b> All internal shelves made out of 18 mm thk MR Grade ply and finished with 0.8 mm thick laminate on top side &amp; including all internal surfaces inside but excluding hidden faces. Shutters should have Brass hinges with ball catchers, magnetic catchers, brass screws, all internal surfaces shall be finished with 0.8 mm thick laminate and wood surfaces, T.W. Beadings, lippings etc. finished with polish complete.  <b>Note: Laminate 1.0 mm thick shall fixed on all the external surfaces i.e front portion, rear portion &amp; all sides of storage rack.</b></p>	58.00		Sqmt.	
16	<p><b>VERTICAL BLINDS</b>            Providing &amp; fixing vertical blinds 100 mm wide of Vista levolor make only of approved shade including C-channel and inclusive of necessary fixtures, fixing, finishing etc. complete.</p>	45.00		Sqmt.	
				C/F	

**TENDER****INTERIOR FURNISHING WORKS**

**NAME OF WORK: TENDER OF INTERIOR FURNISHING WORKS TO BE EXECUTED FOR MAHARASHTRA GRAMIN BANK, NEW PREMISES, 1<sup>st</sup> FLOOR, REGIONAL OFFICE PUNE (M.S.)**

**NAME OF CONTRACTOR \_\_\_\_\_**

Item No.	Description	Quantity	Rate	Per	Amount
			Rs. Ps.		Rs. Ps.
				B/F	
17	<b><u>COLUMN/WALL PANELLING :</u></b> Providing and fixing panelling to Columns/walls or wherever required as directed with 12mm thick ply of MR grade of standard make confirming to I.S.I 303 <b>First Quality</b> (Century- (Century Win)/ Kitply- (Swastik plus)(Greenply (Green MR)1 <sup>st</sup> quality) finishedwith 1.0mm thick laminate (Merinolam//Sunmica/ Formica/Royal Touch) in multicolour and approved pattern and design as directed by the Architect. The rate shall be inclusive of work in Multicolour Laminates, grooves. All necessary hardware, tools and plants required for the work to make to the column in true line and level. T.W. Moulding/beading shall be fixed at lintel level & at false ceiling bottom level made out of 75x75mm T.W. member finished with wooden polish including fixing. etc. Complete.	130.00		Sqmt.	
18	<b><u>COLLAPSIBLE GATE</u></b> Providing and fixing standard M.S. Collapsible Gate at Entrance Door at required places as per requirement as per standard specification and as directed by the Architect, made in outer angle frame of 40x40x5mm including hold fast, fixing, painting, grouting etc. complete	----	----	----	----
19	Providing and applying direct <b>Plastic emulsion Paint</b> of approved quality, colour and shade to old and new surfaces in two coats including scaffolding, preparing the surface. (excluding the primer coat)etc. Complete.	350.00		Sqmt	
19a	Providing and applying two coats of wall care putty on old / new plastered surfaces and ceiling and walls to prepare Surface even and smooth of approved make including scaffolding,finishing etc. Complete	----	----	----	----
20	<b><u>OIL BOUND DISTEMPER</u></b> Providing and applying washable oil-bound distemper of approved colour and shade to old and new surfaces in two coats including scaffolding, preparing the surfaces. (excluding the primer coat.) etc. complete.	100.00		Sqmt	
20a	Providing and applying two coats of wall care putty on old / new plastered surfaces and ceiling and walls to prepare Surface even and smooth of approved make including scaffolding,finishing etc. Complete	100.00		Sqmt	
				C/F	

**TENDER**  
**INTERIOR FURNISHING WORKS**

**NAME OF WORK: TENDER OF INTERIOR FURNISHING WORKS TO BE EXECUTED FOR MAHARASHTRA GRAMIN BANK, NEW PREMISES, 1<sup>st</sup> FLOOR, REGIONAL OFFICE PUNE (M.S.)**

**NAME OF CONTRACTOR** \_\_\_\_\_

Item No.	Description	Quantity	Rate	Per	Amount
			Rs. Ps.		Rs. Ps.
				B/F	
21	Providing & applying <b>synthetic enamel paint</b> of approved shade, make & colour (Asian/Dulux/Berger paints) to Rolling Shutter at entrance M.S. Windows & other M.S.Works including scaffolding, finishing etc. complete.	140.00		Sqmt	
22	<b>DISPLAY BOARD</b> Providing & fixing Display board in customer area and at officers partition as per design and drawing and as directed by the Architect of required height made out of 12 mm thick MR Grade ply of I.S.I. Mark confirming to IS-303 and Soft Board fixed over it with Cloth of approved colour and make finished with 1.0mm thick laminate in moulding fully finished in approved laminate and as directed by Architect.as per drawing and design and as directed with necessary fixtures, hardware, etc. complete. 5 mm thick clear float glass to be used as shutter for display panel fixed with T.W. Moulding beading / Glass Brackets / Glass Holders of required size with necessary itching work as per design & drawing and as directed by the Architect. All inside hidden faces shall be finished with French sprit polish in two or more coats with finishing, carting, erection including T.W. Beading required for Display Panel etc. with all necessary hardware complete	2.50		Sqmt	
23	<b>MIRROR</b> MIRROR PANELING of size 450 X 600 in toilets made out of 6 mm thk mirror of Modi /Asian gobain with 12 mm thk marine ply base with necessary moulding etc. as approved by the Architect.	8.00		No.	
24	<b>Meeting Table (Conference Room)</b> Providing and fixing Meeting Table of size 3000x1800x750 mm in height or as required size made out of 18mm Thick ply of MR Grade of ISI Mark confirming to IS-303 <b>First Quality</b> (Century- (Century Win), Kitply- (Swastik plus) /(Greenply(Green MR)- 1 <sup>st</sup> quality)finished with 1.0mm thick Laminate (Merinolam/Sunmica/Formica/Royal Touch) on exposed outer surfaces and Glass top of 12mm thk. (Modi float/Asahi/ St. Gobain) with beveled Etching as per design, drawing and as directed by the Architect. All internal exposed surfaces shall be finished in 0.8 mm thick laminate & all inside hidden faces except the bottom shall be finished with French sprit polish in two or more coats with finishing, carting, erection including T.W. Beading required for table etc. complete.	3.00		Rmt.	
				C/F	

**TENDER**  
**INTERIOR FURNISHING WORKS**

**NAME OF WORK: TENDER OF INTERIOR FURNISHING WORKS TO BE EXECUTED FOR MAHARASHTRA GRAMIN BANK, NEW PREMISES, 1<sup>st</sup> FLOOR, REGIONAL OFFICE PUNE (M.S.)**

**NAME OF CONTRACTOR \_\_\_\_\_**

Item No.	Description	Quantity	Rate	Per	Amount
			Rs. Ps.		Rs. Ps.
				B/F	
25	<p><b>SEATING ARRANGEMENT</b> <b>Providing &amp; Supplying Sitting Arrangement in Waiting Area For Customers</b> Providing &amp; Supplying Sitting Arrangement with back cushioned sofa work, without Handrest in waiting area for customers in 19mm thk. MR Grade of standard make confirming to IS 303 including all cushion work in 75 mm sitting base &amp; 50 mm (back) U- foam of 32 density (I.S.I. Mark) &amp; 25 mm thk. Rubber foam over U-foam of approved make for seat &amp; back with cloth for bottom &amp; sides of approved make &amp; colour etc. complete. As directed by Architect. ( <b>the cloth rate/fabric rate not exceeding Rs. 900/- per meter</b>)</p>	11.00		Rmt.	
26	<p><b>CENTER TABLE :</b> Providing Centre/Side tables –2Nos. of required sizes and at required positions and as directed by Architect The framework shall be made out of 1st class C.P. Teak wood (free from crack and knots) made out of required size as per drawing &amp; as directed. The table top shall be made of 10 mm thk. Glass with necessary etching work and as directed fixed as per design and as directed inclusive of erection, finishing, etc., complete.</p>	3.00		Nos.	
27	<p>Providing &amp; fixing T.W. Skirting for tables &amp; side racks made out of 100mmx25mm thick T.W. Members as per design and as directed. Finished with melamine polish as per procedures laid down in the specification of melamine polish, including fixing, polishing, finishing etc. complete. The rate shall be inclusive of melamine polish to the wooden members/ mouldings/ beadings etc. complete.</p>	50.00		Rmt	
28	<p><b>FALSE CEILING-</b> Providing and fixing in position Gypsum board false ceiling with 12.5mm thick Gypsum boards, screwed /fixed to the under structure of suspended G.I. Grid constructed and suspended from the main ceiling consisting of ceiling sections of size 25 x 50 mm maximum center to center distance of 600 millimetre perimeter channel and intermediate channels at maximum center to center distance 1200 millimetre</p>				
				C/F	

**TENDER****INTERIOR FURNISHING WORKS**

**NAME OF WORK: TENDER OF INTERIOR FURNISHING WORKS TO BE EXECUTED FOR MAHARASHTRA GRAMIN BANK, NEW PREMISES, 1<sup>st</sup> FLOOR, REGIONAL OFFICE PUNE (M.S.)**

**NAME OF CONTRACTOR \_\_\_\_\_**

Item No.	Description	Quantity	Rate	Per	Amount
			Rs. Ps.		Rs. Ps.
				B/F	
	galvanized grid should be fixed to reinforced cement concrete slab. The gypsum board should be fixed to galvanized iron grid with necessary screws. The boards should be taped and filled from underside to give smooth, seamless ceiling. The rate should include necessary additional ceiling sections and intermediate channels. Additional intermediate channels should be fixed to strap hangers for additional support to prevent strapping at every 1200 milimetre item to be completed in all respect including necessary sleeves for ducts finishing of joints cut outs, painting in Acrylic Emulsion(Dulux/Asian/Berger) including labour, material, lifts etc complete.	410.00		Sqmt	
29	<b>OVERHEAD CABINET</b> Providing & fixing Overhead Cabinates wherever required & as directed by Bank/Bank's Architect of 0.75 mt. Height or as required and as per instructions at the site made out of 18 mm thick plywood MR Grade ply of I.S.I. Mark confirming to I.S. 303 <b>First Quality</b> (Century- (Century Win), Kitply- (Swastik plus)/ (Greenply(Green MR)- 1 <sup>st</sup> quality) finished with 1.0mm thick Laminate (Merinolam/ /Sunmica/ Formica/Royal Touch) as per drawing and as directed by Architect. The frame shall be Made out of 18mm thk. MR Grade ply confirming to I.S. 303 <b>First Quality</b> (Century- (Century Win), Kitply- (Swastik plus)/ (Greenply(Green MR)- 1 <sup>st</sup> quality) finished with 1.0mm thick Laminate (Merinolam/ /Sunmica/ Formica/Royal Touch) as per drawing and as directed by Architect. The shutters shall have overall thickness of 25 mm made out of 12mm thick MR grade ply ISI mark confirming to I.S.I 303 <b>First Quality</b> (Century- (Century Win)/ Kitply- (Swastik plus) / (Greenply(Green MR) Shutter Framework shall be made out of Size 75mmx12mm and 6mm thk ply pressed on Both sides to have thickness of 25 mm with T.W. Beading on edges of shutters finished with 1.0 mm thk Laminate (Merinolam//Sunmica/ Formica/Royal Touch) in multicolour as per design and drawing and of approved shade and colour on external face. All internal shelves made out of 18 mm thk MR Grade ply and finished with 0.8 mm thick laminate on top side	2.00		Sqmt	
				C/F	

**TENDER**

**INTERIOR FURNISHING WORKS**

**NAME OF WORK: TENDER OF INTERIOR FURNISHING WORKS TO BE EXECUTED FOR MAHARASHTRA GRAMIN BANK, NEW PREMISES, 1<sup>st</sup> FLOOR, REGIONAL OFFICE PUNE (M.S.)**

**NAME OF CONTRACTOR \_\_\_\_\_**

Item No.	Description	Quantity	Rate	Per	Amount
			Rs. Ps.		Rs. Ps.
				B/F	
	& including all internal surfaces inside but excluding hidden faces. Shutters should have Brass hinges with ball catchers, magnetic catchers, brass screws, all internal surfaces shall be finished with 0.8 mm thick laminate and wood surfaces, T.W. Beadings, lippings etc. finished with polish complete.				
30	<b>ALUMINIUM COMPOSITE PANELLING at Entrance</b> Providing & fixing in required position 4mm thk. Exterior grade <b>wooden texture aluminium composite panel</b> in ceiling & vertical cladding or as per requirement and directed by the Architect in Composite panel of Metallic /wooden texture Exterior grade of Lennox/ Alto bond/ equivalent make, over a frame work made out of 50x50x2mm, aluminium SHS anchored to existing M.S. Structure/ wall including installing the composite panel in a grid pattern of size 2'-0" x2'-0" (approx) or of <b>required size</b> as directed with the help of aluminium cleats / angle of size 1"x1" and striking out the joints with weather silicon of dow corning 789/wacker make and as directed by the bank's Architect. The rate shall include cutting of panels, its bending cutting for providing down-lighters etc. labour, scaffolding etc. complete.	71.00		Sqmt	
31	<b>DIFFERENCE OF COST FOR VENEER</b> Providing Difference of cost of pasting/fixing teak texture Veneer 4mm thick directly over 12 mm thick plywood on external faces wherever required and as directed in lieu of 1.00 thick laminate on external faces including fixing with hitex or equivalent glue/ chemical for fixing directly over 12mm th. Plywood as directed. approved shed & colour etc. complete. As directed by Architect. <b>(Veneer minimum Rate is Rs. 150/- per Sqft.)</b>	150.00		Sqmt.	
32	Providing and applying melamine polish of required finish to the wood / Veneer work by spray machine including knotting and preparing the even surface by scraping, applying wooden polish, scaffolding W if required etc. Complete. As directed by Architect.	150.00		Sqmt.	
				C/F	

**TENDER**

**INTERIOR FURNISHING WORKS**

**NAME OF WORK: TENDER OF INTERIOR FURNISHING WORKS TO BE EXECUTED FOR MAHARASHTRA GRAMIN BANK, NEW PREMISES, 1<sup>st</sup> FLOOR, REGIONAL OFFICE PUNE (M.S.)**

**NAME OF CONTRACTOR \_\_\_\_\_**

Item No.	Description	Quantity	Rate	Per	Amount
			Rs. Ps.		Rs. Ps.
				B/F	
33	<b><u>COLUMN/WALL PANELLING</u></b> Providing and fixing panelling to Columns/walls or wherever required as directed with 12mm thick ply of MR grade of standard make Confirming to IS-303 1st quality Greenply(Green MR)/ Century ply(Century Win)/ Kitply(Swastik plus)/ finished with 1.0mm thick Laminate (Merino/ Sunmica/Formica / Royal Touch or equivalent) in multicolour and approved pattern and design as directed by the Architect. The rate shall be inclusive of work in T.W. Members/ aluminium sections to bring the surface/work in true lines and level in Multicolour Laminates, grooves. All Necessary hardware, tools and plants required for the work to make to the column/wall surfaces in true line and level.	90.00		Sqmt.	
34	<b><u>CHAIR FOR Regional Office.</u></b> Providing & supplying the chairs as per required of Methodex System Pvt. Ltd. Or Godrej make. complete as follows:				
	a)RM Chair High Back	2.00		Nos.	
	b)CM Chair & Officer, premium series, MHB type Medium Back	15.00		Nos.	
	c) Chair for Clerks / Meeting X Series, X-17 type	27.00		Nos.	
	d) Chair for Visitors, Visitor Series, V-32 Type	12.00		Nos.	
35	<b><u>TRANSIT ROOM BEDS</u></b> Providing individual beds for Transit room 0.90mts x 2.10 mts or as directed and of required height (0.45 mts. ht. Including thickness of mattress) made out of 18mm thick commercial ply ISI make confirming to IS:303, First Quality (Century- (Century Win), Kitply- (Swastik plus)/ (Greenply (Green MR)- 1 <sup>st</sup> quality) with one full length drawer on floor wheels/castors & on full length side channels of ISI make, width of the bed side i.e. 0.90 mts. Upto a depth of 2.00 mts. (appx.) with frame work made out of 18mm thick plywood (total thickness 36mm) for frame work & Teak Wood members frame work on corners & wherever required, with 12mm thick plywood on top with necessary frame work to fix the top plywood. As per drawing and as directed The bed shall be finished with 1.00 mm thick <b>laminat</b> e (Merinolam/Sunmica/ Formica/Royal Touch) externally & exposed external	3.00		No.	
				C/F	



**TENDER**  
**INTERIOR FURNISHING WORKS**

**NAME OF WORK: TENDER OF INTERIOR FURNISHING WORKS TO BE EXECUTED FOR MAHARASHTRA GRAMIN BANK, NEW PREMISES, 1<sup>st</sup> FLOOR, REGIONAL OFFICE PUNE (M.S.)**

**NAME OF CONTRACTOR \_\_\_\_\_**

Item No.	Description	Quantity	Rate	Per	Amount
			Rs. Ps.		Rs. Ps.
				B/F	
	wooden surfaces shall be finished with high class Wooden polish including al hardware adhesives, nails, screws etc. Complete. The work is to be carried out as per plan, design, drawers, details etc. Complete. The drawers are to be finished with 0.80 mm thick laminate internally including finishing, lipping, adhesives, polishing, etc. complete. Any Omissions in required specifications not mentioned in the detailed specifications required for effective completion of the work shall not be paid extra & shall be assumed to be included in the scope of work and the said works are to be completed as per the directions of Bank's Architect.				
36	<b>SIDE TABLES</b> The beds are to be provided with side tables (600x450x450 approx.) as per plan, drawings, designs, etc. complete. and with following specifications. Side table shall be provided with 2no. drawers on drawer channels as per drawing & details. Tables are to be finished with 1.00 mm thick laminate (made out of (Merinolam/Sunmica/ Formica/Royal Touch) externally all around & to match with beds in interiors. The internal surface of drawer shall be finished with 0.80 mm thick laminate & work includes all hardware, nails, screws, S.S. Finished handels castors etc. complete. The drawer are to be made out of 18 mm thick plywood finished with 1.00 mm thick laminate externally & 0.80 mm thick internals with S.S. Handels. Any omissions in required specifications not mentioned in the detailed specifications required for effective completion of the work shall not be paid extra & shall be assumed to be included in the scope of work and the said works are to be completed as per the directions of Bank's Architect.	3.00		No.	
				C/F	

**TENDER**  
**INTERIOR FURNISHING WORKS**

**NAME OF WORK: TENDER OF INTERIOR FURNISHING WORKS TO BE EXECUTED FOR  
MAHARASHTRA GRAMIN BANK, NEW PREMISES, 1<sup>st</sup> FLOOR, REGIONAL OFFICE PUNE (M.S.)**

**NAME OF CONTRACTOR** \_\_\_\_\_

Item No.	Description	Quantity	Rate	Per	Amount
			Rs. Ps.		Rs. Ps.
				B/F	
37	<b>MIRROR FIXING/ DRESSING TABLE AT ROOM</b> Providing and fixing 6mm thick mirror (modi/Asahi/ St. Gobain ) fixed on 12 mm thk. Plywood backing with edge polishing and laminated plywood border on all sides as per design and as directed inclusive of platform for dressing of 350 mm wide and required length as per drawing and design with two drawers made out of 18 mm thick commercial plywood of ISI Mark finished with 1.00 mm thick <b>lamine</b> externally and Finished with 0.80 mm thick laminate internally Including all hardware, adhesive/ silicon, adhesive and including carting, lifting, fixing @ required position, furnishing etc. complete.	2.00		Sqmt.	
38	<b>FIXING OF CURTAIN RODS</b> Providing & fixing Stainless Steel curtain rods 25mm diameter with brackets including all hardware etc. complete and as per Bank's Architect/ competent Authority and as directed etc. complete.	6.00		Rmt.	
39	<b>MATTRESS</b> Providing & laying 130mm thick Bonded foam mattress of sleepwell/ equivalent make as per Company's standard specification and of required Size 0.90m x 2.10m.	3.00		No.	
40	<b>PILLOW</b> Providing & laying pillow of sleepwell/ equivalent make as per Company's standard specification and of required size 0.55m x 0.30m.	3.00		No.	
	Total				
				<b>Say Rs.</b>	

**NOTE**

**Any omissions in required specifications not mentioned in the detailed specifications required for effective completion of the work shall not be paid extra & shall be assumed to be included in the scope of work and the said works are to be completed as per the directions of Bank's Architect.**

**Signature of Contractor/  
Tenderer with seal**

**Chairman**  
Maharashtra Gramin Bank,  
Head office, Aurangabad. (M.S.)

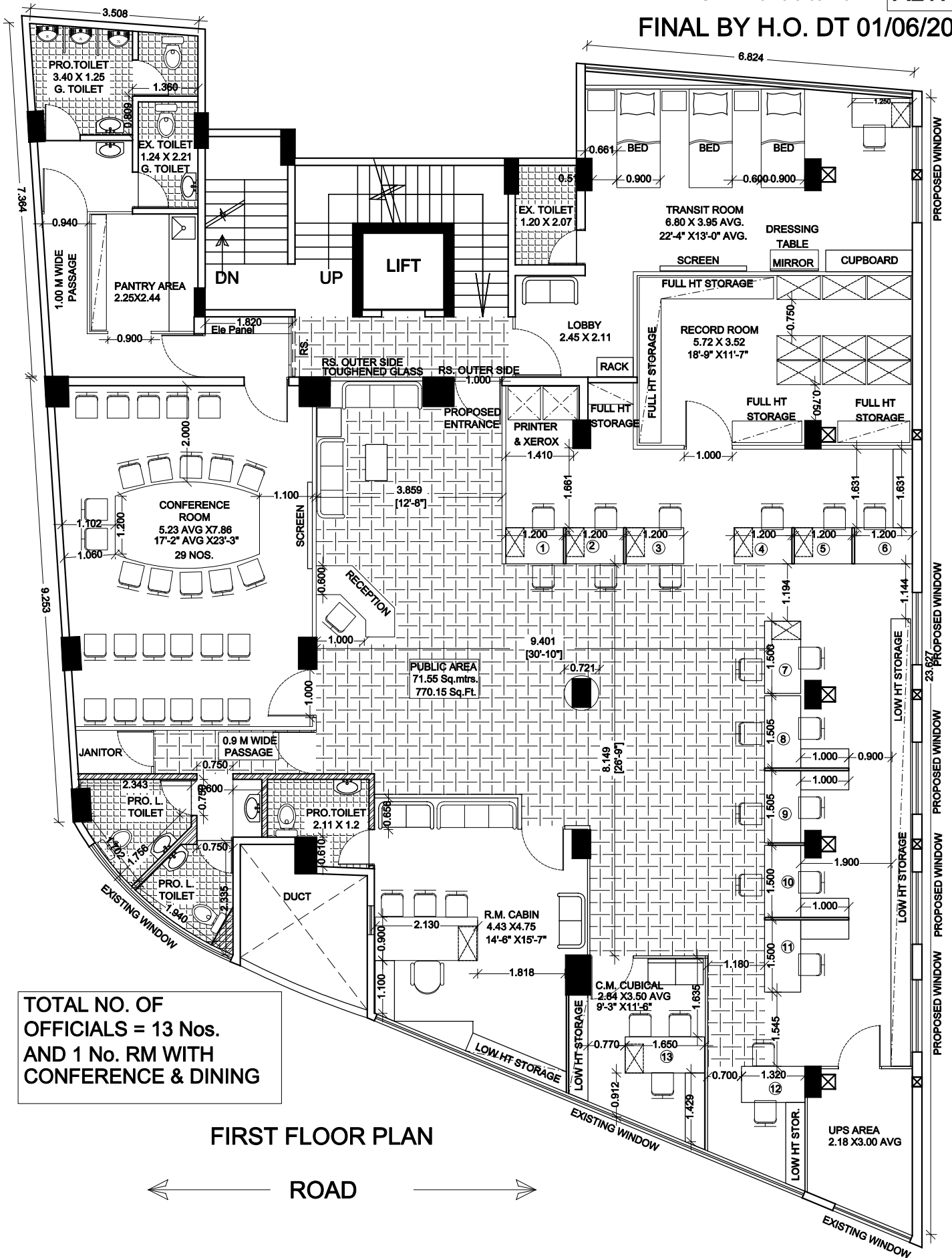

TOTAL NO. OF OFFICIALS = 13 Nos.  
 AND 1 No. RM WITH CONFERENCE & DINING

FIRST FLOOR PLAN



PROPOSED PLAN FOR MAHARASHTRA GRAMIN BANK,  
 NEW PREMISES, REGIONAL OFFICE, PUNE.

PROPOSED DRAWING	ARCHITECT :-
DRG. NO. :- Alt. No. 01A	ASHISH S. NASHINE
SCALE :-	B- ARCH., M. I. C. A., A. I. I. A.,
DATE :- 01/06/2022	49, BAJAJ NAGAR
DEALT :- SINGH	NAGPUR - 10
	PH. No. 2231679, 2240670



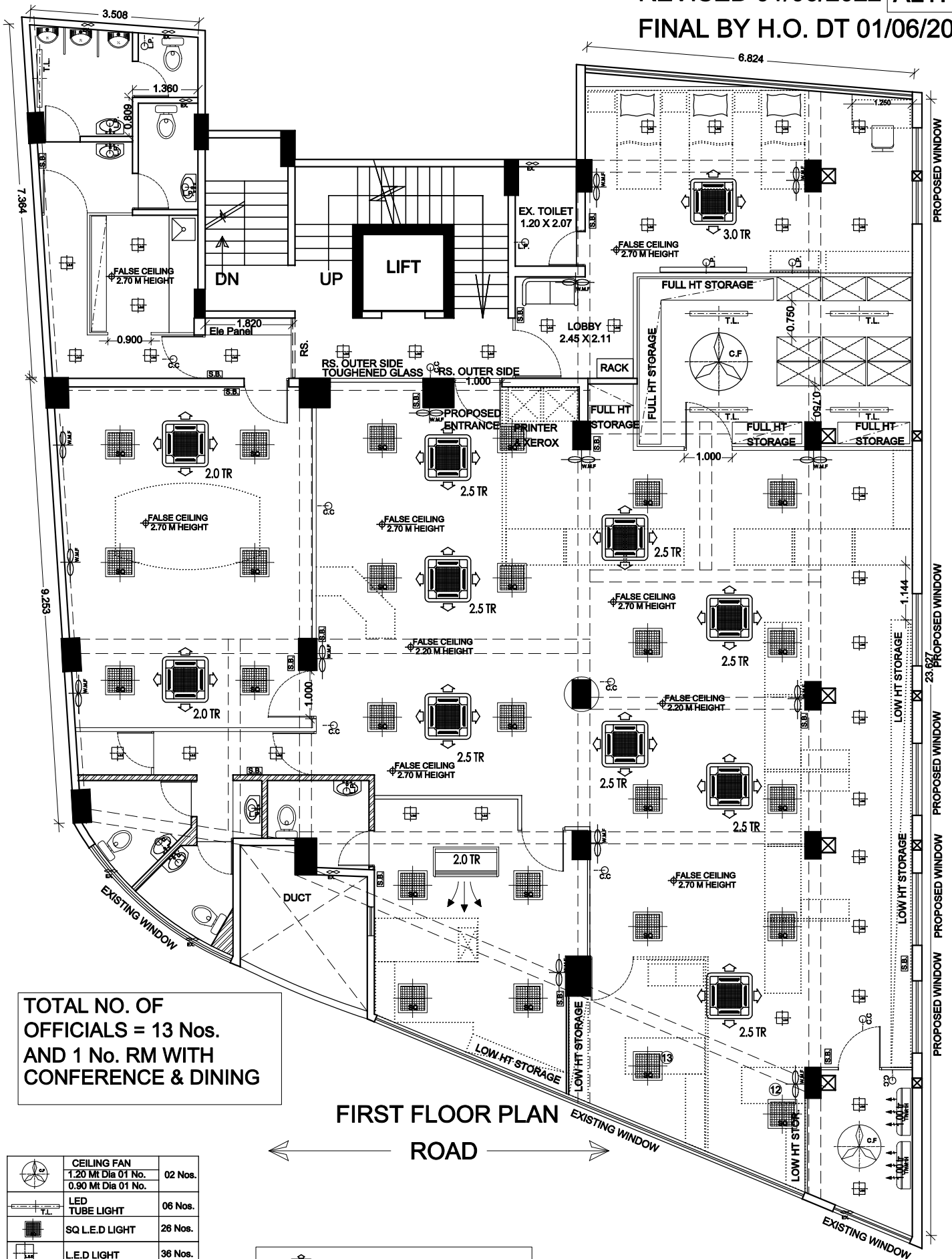

**TOTAL NO. OF OFFICIALS = 13 Nos. AND 1 No. RM WITH CONFERENCE & DINING**

**FIRST FLOOR PLAN**  
 ROAD

	CEILING FAN 1.20 Mt Dia 01 No. 0.90 Mt Dia 01 No.	02 Nos.
	LED TUBE LIGHT	06 Nos.
	SQ L.E.D LIGHT	26 Nos.
	L.E.D LIGHT	36 Nos.
	WALL FAN	15 Nos.
	SPEAKERS	14 Nos.
	EXHAUST FAN	08 Nos.
	LIGHT POINT	12 Nos.
	SWITCH BOARD	15 Nos.
	COOLER POINT	05 Nos.
	CAMERA	08 Nos.

	2.50 tr 4 Way Cassette (8 Nos.)
	2.00 tr 4 Way Cassette (2 Nos.)
	3.00 tr 4 Way Cassette (1 Nos.)
	2.00 tr 1 Way Cassette (1 Nos.)
	1.00 tr Split AC (2 Nos.)

**PROPOSED PLAN FOR MAHARASHTRA GRAMIN BANK, NEW PREMISES, REGIONAL OFFICE, PUNE.**

PROPOSED DRAWING	ARCHITECT :-
DRG. NO. :- Alt. No. 01A	ASHISH S. NASHINE
SCALE :-	B- ARCH., M. I. C. A., A. I. I. A.,
DATE :- 02/06/2022	49, BAJAJ NAGAR
DEALT :- SINGH	NAGPUR - 10
	PH. No. 2231679, 2240670

